

**Attaching any of the supplied Attachments**

Align slot on attachment with pin on top surface of bent arm illuminator and push until secure. (Fig. 11).

**Replacing lamp**

Remove by turning counter-clockwise. Reverse procedure to replace (Item #5211-4).

**Care and Maintenance**

Disinfection: We recommend soaking in disinfection or thermo-chemical disinfection at up to 65°C in a washer sterilizer. Adhere strictly to manufacturer's instructions regarding concentration and duration. After disinfection, thoroughly rinse in sterile water to remove and dry with a soft cloth. Devices can be disinfected at temperatures up to 95°C without the addition of chemical additives. Autoclaving: Autoclaving may be used for the attachments at up to 134°C max, but will reduce the life of the instruments.

**Nasal Specula Attachment:** (provided on Item #5215)

This instrument head attachment (Item #5215-NS) is designed for examination of the nasal cavity. It is used in conjunction with the Otoscope instrument head.

**Attaching Nasal Specula**

This instrument must be used in conjunction with the Otoscope head (Item #5220). Attach Otoscope head to the battery handle. Remove ear specula or adaptor. Attach Nasal Specula by pushing the flanged end of the desired specula onto the instrument head aligning the slot in the specula flange with the rivet at the top of the instrument head and twist clockwise to engage. Reverse procedure to remove. (Fig. 12).

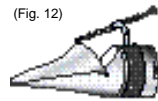

**Operating Nasal Specula**

To open, turn thumb screw counter-clockwise. To close reverse procedure.

**Care and Maintenance**

Disinfection: We recommend soaking in disinfection or thermo-chemical disinfection at up to 65°C in a washer sterilizer. Adhere strictly to manufacturer's instructions regarding concentration and duration. After disinfection, thoroughly rinse in sterile water to remove sterilizer and dry with a soft cloth. Devices can be disinfected at temperatures up to 95°C without addition of chemical additives. Autoclaving: Autoclaving may be used for Nasal Specula at up to 134°C max, but will reduce the life of instruments.

Item#	For Use In	Description
5122	5211	Insufflator Bulb, Otoscope
5181	5211	Disp. Specula, 2.5mm, 1000/pkg
5184	5211	Disp. Specula, 4.0mm, 1000/pkg
5215-TD	5215	Tongue Depressor Attachment
5260	5210, 5211, 5211V, 5215, 5312	Battery Handle, "C" Cell
5220	5210, 5211, 5211V, 5215	Otoscope Head for Otoscope, Standard, and Complete Diagnostic Sets
5240	5210, 5215	Ophthalmoscope Head for Standard and Complete Diagnostic Sets
5215-TH	5215	Bent Arm Illuminator
5215-M3	5215	Laryngeal Mirror, 3mm
5215-M4	5215	Laryngeal Mirror, 4mm
5215-MS	5215	Nasal Speculum For Diagnostic Set
5215-TD	5215	Metal Tongue Depressor
5211-AD	5211	Ear Specula Adaptor for Welch Allyn
5211-1	5211	Ear Specula, 2.5 mm
5211-2	5211	Ear Specula, 3.5 mm
5211-3	5211	Ear Specula, 4.5 mm
5211-7	5211V	Ear Specula, 4.0 mm
5211-8	5211V	Ear Specula, 5.0 mm
5211-9	5211V	Ear Specula, 7.0 mm
5210-4	5210	Lamp, 2.5v for Ophthalmoscope
5211-4	5211, 5211V	Lamp, 2.5v for Otoscope
5210-2C	5210	Zipper Case for Diagnostic Set
5215-2C	5215	Zipper Case for Complete Set

# A Special Thank You...

Thank you for choosing an ADC 2.5v diagnostic instrument. We're proud of the care and quality that goes into the manufacture of each and every diagnostic instrument that bears our name. Only the finest materials are used to assure you of a timeless instrument designed for optimum performance. You'll quickly appreciate the results for you now own one of the finest diagnostic instruments that money can buy. With proper care and maintenance your ADC diagnostic instrument is sure to provide you with many years of dependable service. Please read the following instructions and general information which will prove helpful in allowing you to enjoy your ADC product. Thank you for your patronage. It is indeed our pleasure to serve you.

Sincerely,  
American Diagnostic Corp.

**Parts and Assembly**

**Introduction**

This instruction manual is for use with the Complete 2.5v Instrument Set (Item #5215), 2.5v Diagnostic Set (Item #5210), 2.5v Otoscope (Item #5211 or 5211V), and all accessories and replacement parts.

**Battery Handle**

All instrument sets come equipped with a "C" cell knurled chrome handle with rheostatic power switch (Item #5260)

**Battery Replacement:**

Requires 2 "C" cell batteries. Remove the knurled cap at the base of the handle by turning counter clockwise. Insert two fresh "C" cell batteries (not included) with the positive polarity towards the instrument head. Replace battery compartment cap by turning clockwise. (Fig. 1).

**Removing and Attaching the Instrument Head:**

All instrument heads feature a bayonette style mount. To remove, push down firmly and rotate counter-clockwise. To engage, align slots on base of instrument head with tabs on bayonette. Push head and twist clockwise until engaged. (Fig. 2).

**Turning the instrument on:**

To illuminate, press the white power switch and rotate the rheostatic bezel clockwise until desired lamp intensity is obtained (0 position is off, red 1 position is full power) Slide the switch in the opposite direction to turn off. (Fig. 3).

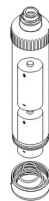

(Fig. 1)



(Fig. 2)



(Fig. 3)

**Limited Warranty**

American Diagnostic Corporation (ADC) warrants its products against defects in materials and workmanship under normal use and service as follows:

1. Warranty service extends to the original retail purchaser only and commences with the date of delivery.
2. The optical system is warranted for one year.

**What is Covered:** Repair, or replacement of parts, and labor.

**What is not covered:** Transportation charges to and from ADC. Damages caused by abuse, misuse, accident, or negligence. Incidental, special, or consequential damages. Some states do not allow the exclusion or limitation of incidental, special, or consequential damages, so this limitation may not apply to you.

**To Obtain Warranty Service:** Send item(s) postage paid to ADC, Attn: Repair Dept., 55 Commerce Dr., Hauppauge, NY 11788. Please include your name and address, phone no., proof of purchase, and \$2.00 to cover the cost of return shipping and handling.

**Implied Warranty:** Any implied warranty shall be limited in duration to the terms of this warranty and in no case beyond the original selling price (except where prohibited by law). This warranty gives you specific legal rights and you may have other rights which vary from state to state.

**Handle Care and Maintenance**

The handle can be cleaned with a moist cloth or alcohol wipe. Do NOT immerse the handle in any liquid. Periodically check the condition of the batteries, making sure there is no sign of corrosion or oxidation. Always replace BOTH batteries. Alkaline batteries are recommended. Remove batteries from handle if instrument will not be used for an extended period of time.

**Instrument heads**

Otoscope Head (provided on 5215, 5210, 5211, and 5211V) (Item #5220). This instrument head is designed for examination of the ear canal – specifically the external acoustic duct and tympanic membrane. The head comes complete with a 3x removable viewing lens, insufflator fitting, and 3 specula (standard models with 2.5mm, 3.5mm, and 4.5mm specula, veterinary model with 4mm, 5mm, and 7mm specula).

**Attaching the specula:**

Push the flanged end of the desired specula onto the instrument head aligning the slot in the specula flange with the rivet at the top of the instrument head and twist clockwise to engage. Reverse procedure to remove. (Fig. 4).

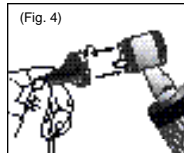

(Fig. 4)

**Using Welch Allyn or equivalent disposable specula:**

Attach the disposable specula adaptor, Item #5211-AD in the same manner as the reusable specula. Attach Welch Allyn or equivalent disposable specula by pushing the flanged end of the desired specula onto the chrome socket and twist counter-clockwise to engage. Reverse procedure to remove and discard after each use.

To Register Your Product, visit us at [www.adctoday.com](http://www.adctoday.com) and follow the links

FOR QUESTIONS, COMMENTS, or SUGGESTIONS CALL TOLL FREE: 1-800-ADC-2670



55 Commerce Drive • Hauppauge, NY 11788  
[www.adctoday.com](http://www.adctoday.com)

Part# 93-5215-00 Printed in the U.S.A.

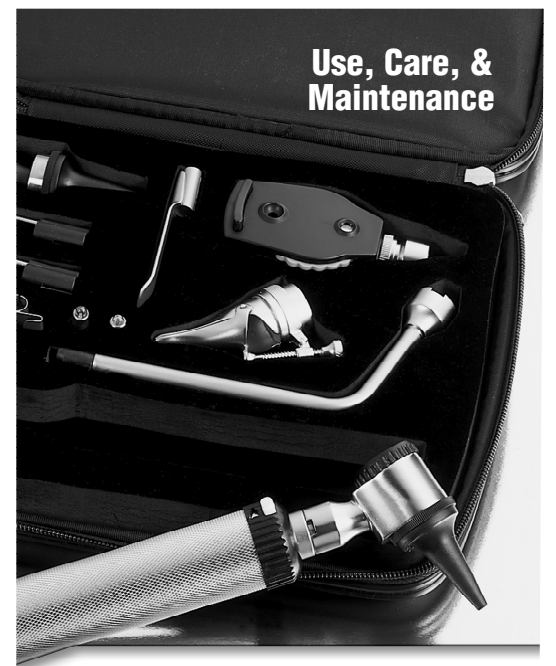

**Otoscope / Ophthalmoscope Instrument Set**

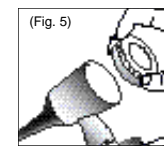

(Fig. 5)

**Removing Viewing lens:**

To remove during an examination, rotate lens counter-clockwise and pull. Reverse procedure to attach. (Fig. 5).

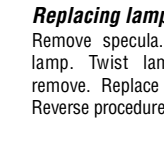

(Fig. 7)

**Replacing lamp:**

Remove specula. Pull black sleeve off of lamp. Twist lamp counter-clockwise to remove. Replace with ADC Item #5211-4. Reverse procedure to install new lamp. (Fig. 6).

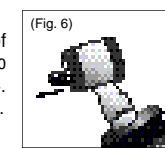

(Fig. 6)

**Insufflator**

The unit comes equipped with an insufflator fitting already attached. The insufflator bulb (Item #5122) can be purchased separately. (Fig. 7).

**Ophthalmoscope Head**

(provided on set #5215 and #5210) This instrument head (Item #5240) is designed for examination of the fundus, and other ocular structures. The head is equipped with 25 lenses from -25 to +40 diopters. (Fig. 8).



(Fig. 8)

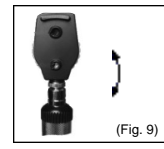

(Fig. 9)

**Corrective lens selection:**

Unit is equipped with 25 corrective lenses from +40 to -25 diopters (negative lenses in red). To select, rotate the corrective lens selection wheel at either side of the instrument head. Selected lenses can be viewed in the illuminated panel. (Fig. 9).

**Replacing Halogen lamp:**

Remove the Ophthalmoscope head by turning counter-clockwise. Grab end of lamp from inside base of Ophthalmoscope head and remove. Replace with new lamp (Item #5210-4), taking care not to touch the glass, and align lamp metal guides on side of lamp with grooves in lamp socket. (Fig. 10).



(Fig. 10)

**Cleaning:** Head can be cleaned with a moist cloth or alcohol wipe. Remove lamp first. Do NOT immerse head in any liquid.

**Bent Arm Illuminator Head:**

(Item #5215-TH). This instrument head is designed for examination of the oral cavity in conjunction with the tongue depressor blade, or laryngeal mirror attachments. Supplied attachments include a reusable tongue blade (Item #5215-TD), adaptor for disposable tongue blade (Item #5215-TO), 3mm laryngeal mirror (Item #5215-M3), and 4mm laryngeal mirror (Item #5215-M4). These attachments are supplied with complete set (Item #5215) only or can be purchased separately. (Fig. 11).

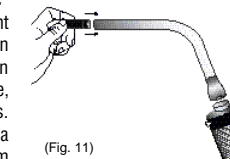

(Fig. 11)