

PRO-LINE™ CABINETY

Price includes enough countertop to cover each base cabinet. Order GTP-TOP below for extended countertops. Must specify hinging on (1) door cabinets: R = Right Hinged / L = Left Hinged. Cabinet selection and countertop size can be varied to suit your needs. Groups are available as shown or opposite hand. All groups available with optional S sink. (Please specify on order.)

OPTIONS FACTORY INSTALLED

- S** – Sink & Faucet 15" x 15" (12" x 10" x 5" I.D.)
- LOCK** – Single Drawer or Door Lock
- LOCK-BOLT** – Lock & Bolt for double Doors
- 3mm** – High impact edging on Doors & Drawer Fronts.

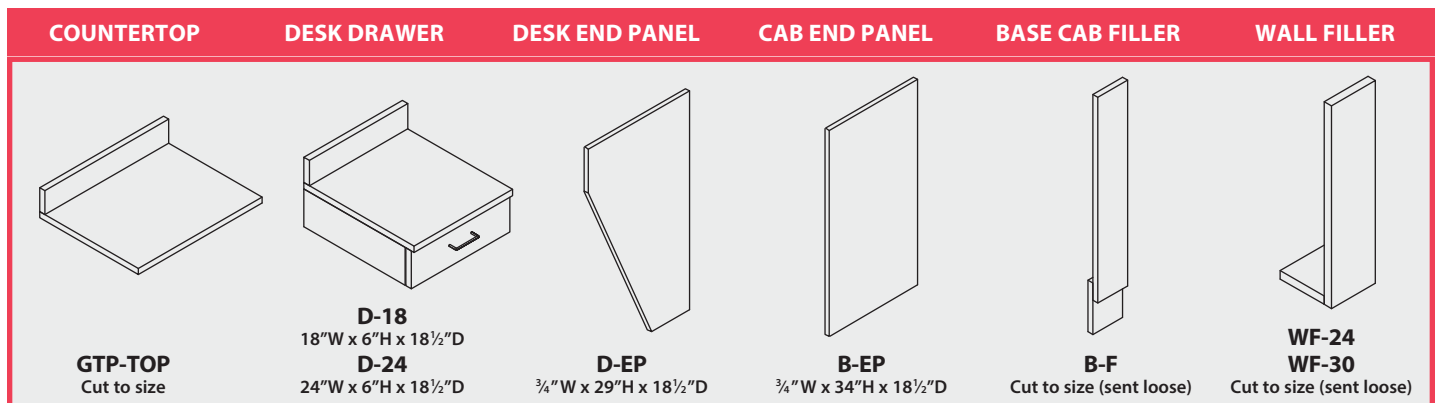
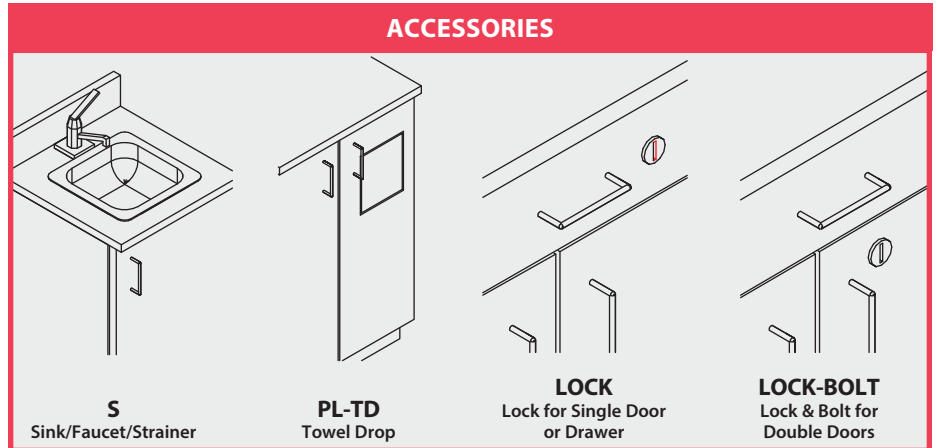

A. Model GLR-B4 Free-Standing Cabinet Unit

FEATURES:

- (5) 24" wide Drawers on nylon rollers.
- (1) 24" wide storage Door section with adjustable shelf.
- 36" high Countertop surface.
- (2) 24" wide x 10" deep upper solid door cupboards each with (1) adjustable shelf.

MODEL	LENGTH	DEPTH	HEIGHT
GLR-B4	49½"	18"	77"

B. Model GLR-A1 Free-Standing Unit with Sink

FEATURES:

- (2) 24" wide Drawers with Doors below.
- (1) 24" wide Door section with shelf.
- 36" high Countertop surface.
- (4) Upper Framed Acrylic Doors.
- (2) Upper 10" deep cupboards with shelf.
- Stainless Steel Sink (10" x 12" x 5") and Faucet.

MODEL	LENGTH	DEPTH	HEIGHT
GLR-A1	49½"	18"	77"



A. Model GLR-B4



B. Model GLR-A1