

MEDICAL FLOOR SCALE

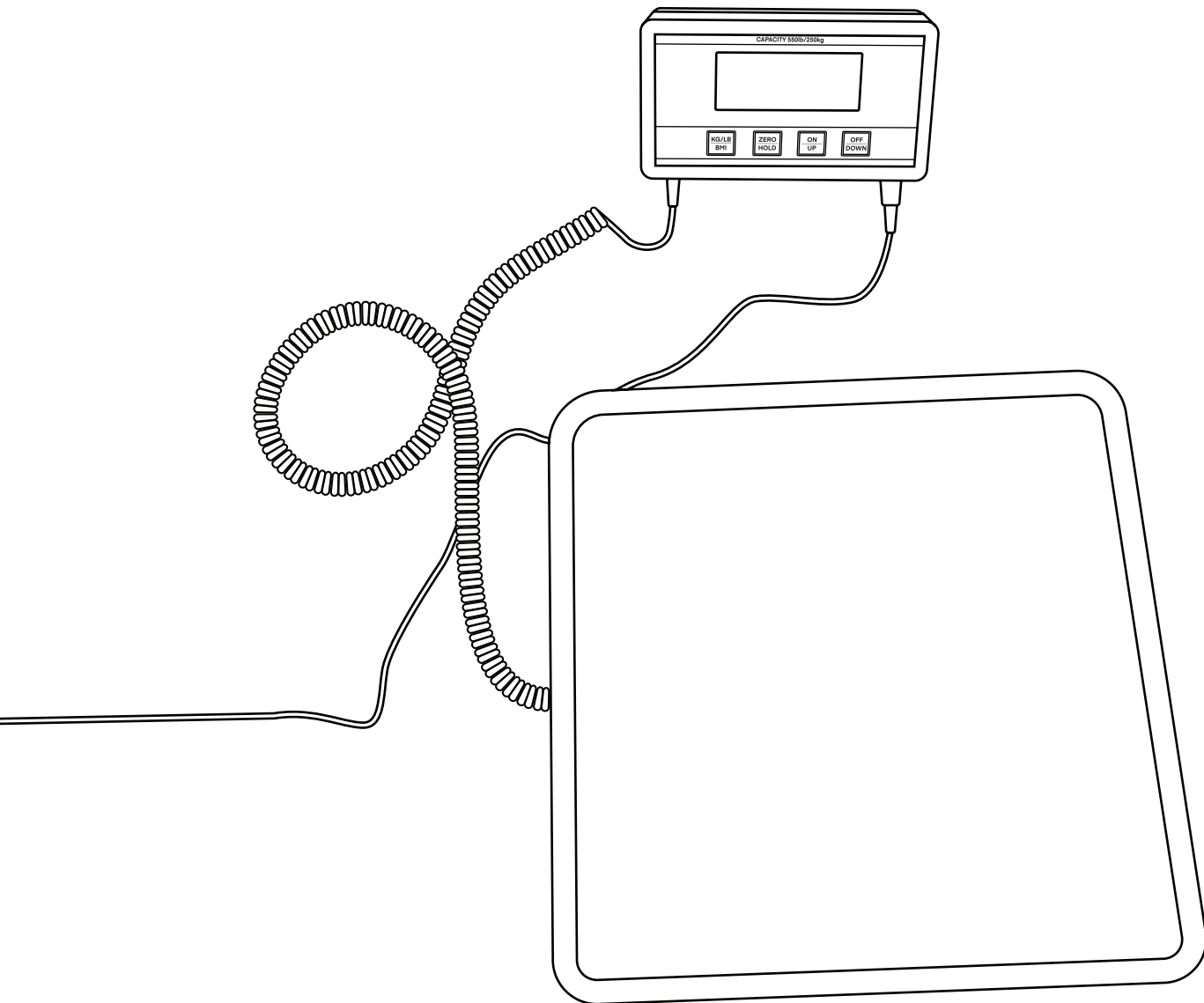

USER GUIDE

ADIME904-06



Thank you for your purchase.



Viva Comfort maintains a strong practice of ongoing development of products and commercial research.



We recognize that starting and maintaining a medical practice is expensive. We'll help make the process cost-effective and elegant. Additionally, our team of specialists will ensure everything you need works as efficiently as possible, so you can effectively treat your clients.

Table of Contents

2	Parts List
3	Hardware List
4	Mounting Instructions
5	Assembly Instructions
7	Operational Method
9	Special Features
9	Understanding Messaging
10	Specifications
10	Compliance
10	Care and Cleaning
11	Warranty

Parts List

A

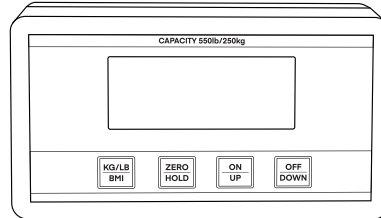

Interface

B

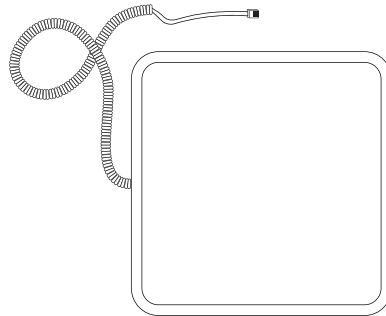

Scale

C

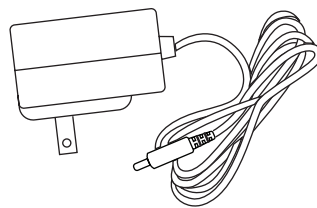

Power Supply (AC Adapter)

Hardware List

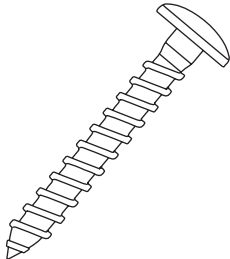
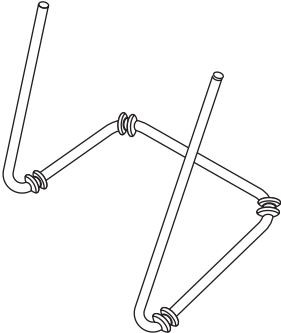
1	 <p>Plastic Anchor (x2)</p>
2	 <p>Screw (x2)</p>
3	 <p>Bracket (x1)</p>

Mounting Instructions

Using the Bracket

- A. Locate the Bracket (3) and the Interface (A).
- B. On the back of the interface there are two parallel vertical indents.
- C. Clip the Bracket (3) into the Interface (A) until secure.

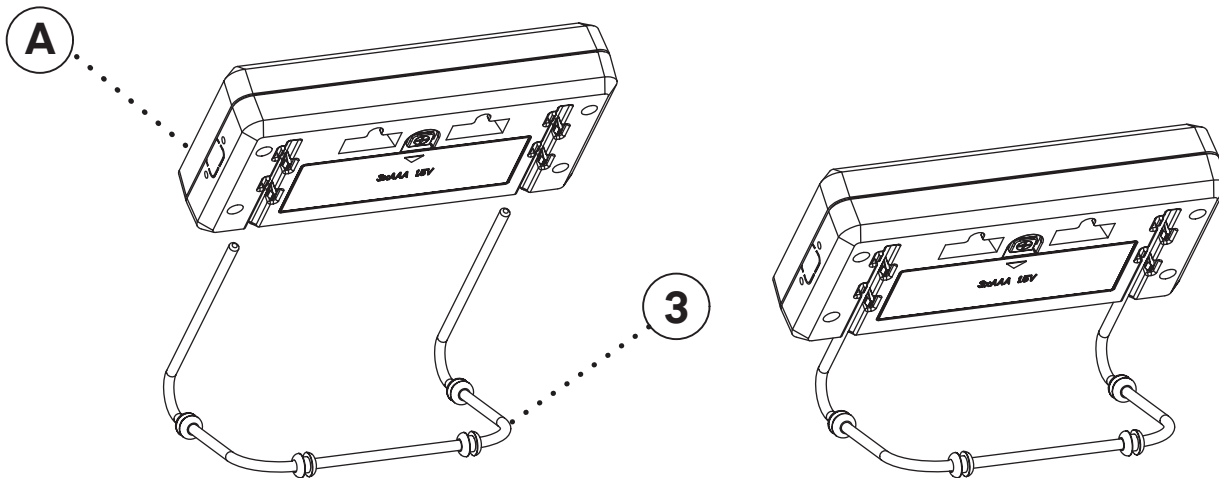

Mounting to a Wall

- A. Use a stud finder before drilling. If you cannot find a stud close to where you need to install it, proceed to the next step.
- B. Depending on the height you wish to have your Interface (A) mounted, measure the height, up to 9 ft.
 - a. Mark on the wall the height you wish to mount it.
- C. From the first mark, measure 1 - 13/16" and mark the wall.
 - a. These will be your center lines for drilling.
- D. Drill through both marks on the wall.
- E. Insert both Plastic Anchors (1) into the holes, and secure both Screws (2) using a Philips head screwdriver.
- F. Mount the back of Interface (A) onto the Screws (2).

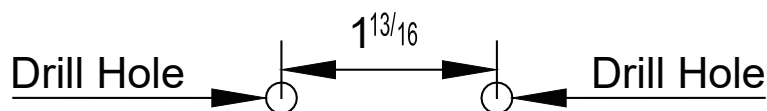

Assembly Instructions

Step 1:

A. Connect the cable from the Scale (B) to the left side of the Interface (A).

B. Connect the Power Supply (C) to the right side of the Interface (A)

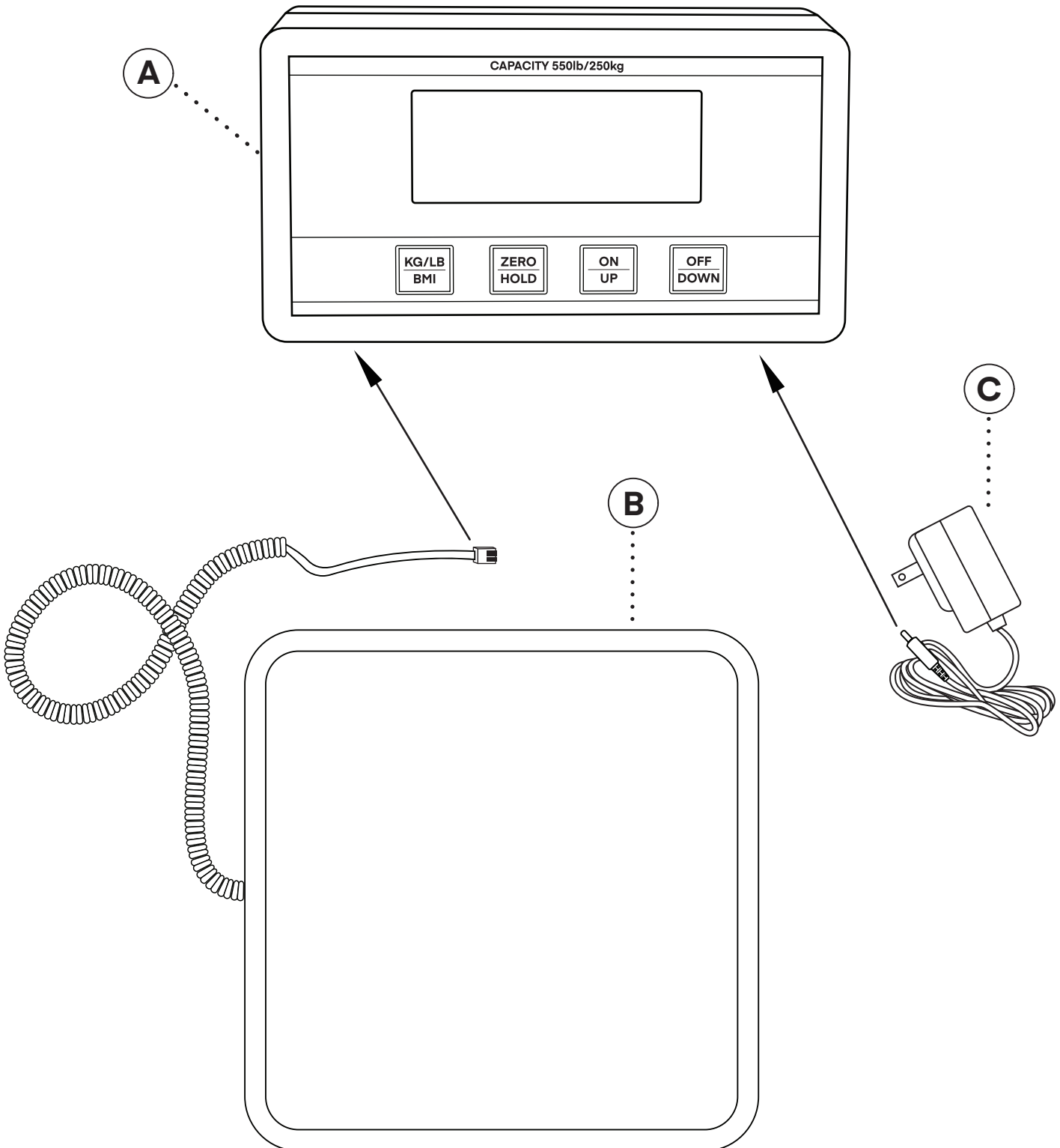

Step 2:

A. To use the Interface (A) without the corded Power Supply (C), remove the back cover.

B. Insert three 1.5V batteries into the back of the Interface (A), and apply the cover.

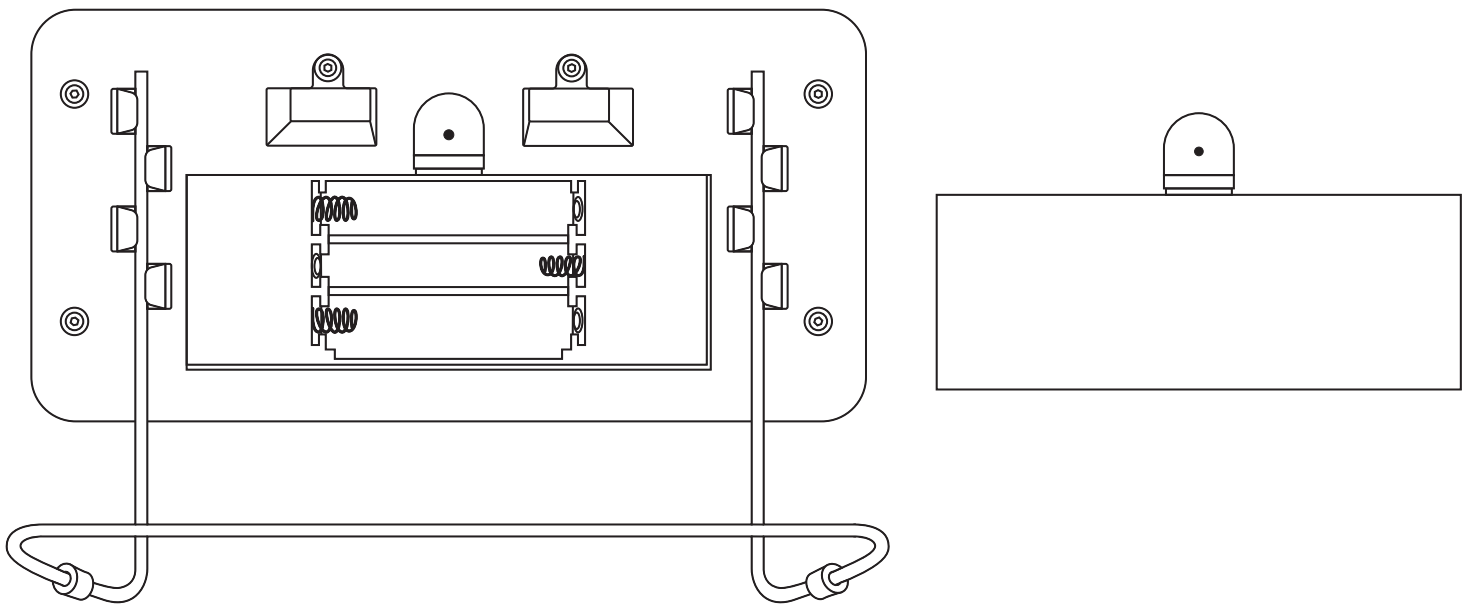
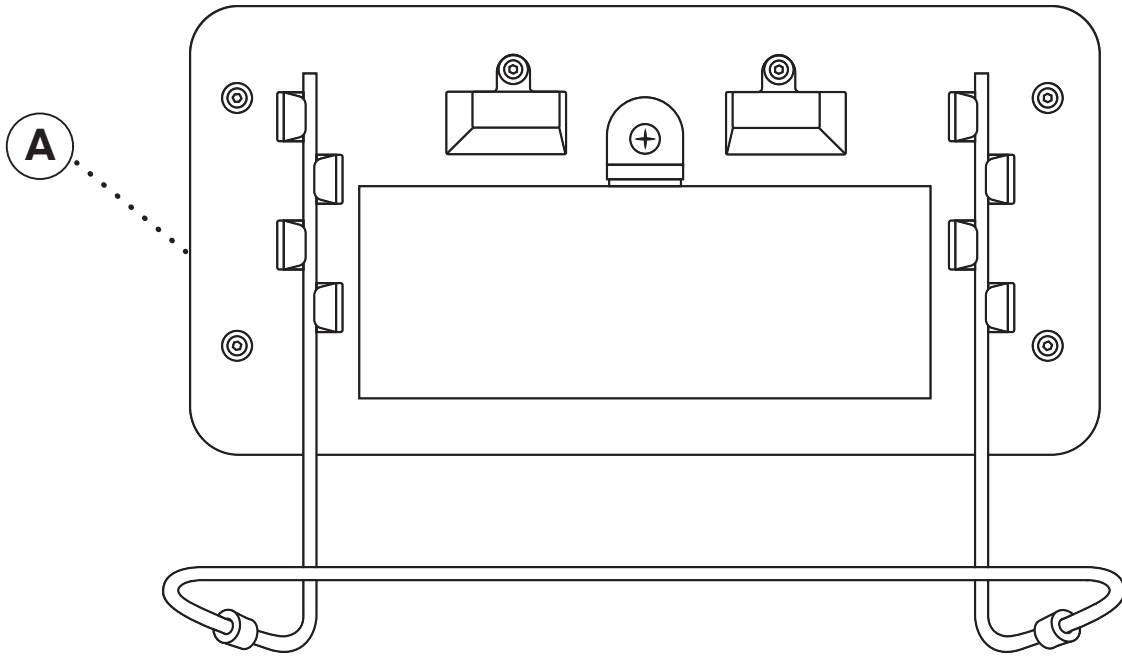

Operational Method

Power Supply

Your Scale (B) operates on three, 1.5V batteries or the AC adapter.

- A. BATTERY USE:** The battery compartment is located on underside of the Interface (A). Connect battery \pm accordingly.
- B. AC ADAPTER USE:** First plug into bottom right of Interface (A), then plug the Power Supply (C) in a wall outlet.

NOTE: When using the AC adapter, if display fluctuates between "----" and numbers, reverse adapter in wall outlet.

Preparing Scale for Use

- A.** Remove the plastic film from display.
- B.** Plug coiled display cord into the bottom left of the Interface (A).

Operating Instructions

- A.** Place the Scale (B) on a vibration free, level surface.
- B.** Press the "ON/UP" button. Wait for the Interface (A) to show 0.0 lb.
 - a.** You can then weigh objects on the scale.
- C.** Allow the display to return to zero before weighing.
- D.** To activate "HOLD" please press "ZERO/HOLD" button for 3 seconds.
- E.** To deactivate the "HOLD" press the "ZERO/HOLD" button.
 - c.** Press "ZERO/HOLD" after object is added.

Using the Scale

- A.** Press "ZERO/HOLD" after the object is added.
- B.** Press "ZERO/HOLD" each time additional material is added to the container.

POWER ON



UNITS

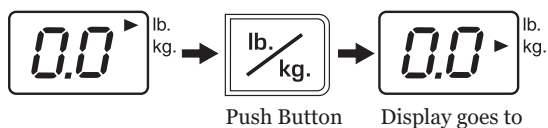

Ze ro

Returns scale to 0.0. Acts as a "tare" to offset weight.

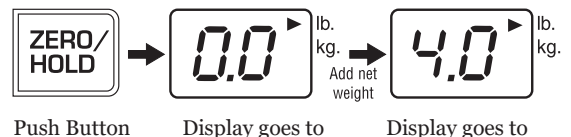

BMI Function

Body Mass Index (BMI) is a ratio between a person's weight and height and interpreted as BMI score.

- A.** With all weight off the scale, press the "ON/UP " button.
- B.** Wait until "0.0" lb or "0.0" kg, then, stand onto the scale."LOCK" will appear and when a stable weight is determined. The weight will also be displayed.
- C.** After obtaining the weight, press the press the "KG.LB/BMI" button.
- D.** The display will show 170mm (in KG mode) or 67 inches (in LB mode). Use "ON/UP" and "OFF/DOWN" button to enter the height in centimeters if weighing in kg or inches if weight in lb.
- E.** Once height is keyed in, press the "ZERO/HOLD" button.
- F.** The display will show the BMI.
- G.** Press the "KG.LB/BMI" button, show weight.

Locking the Unit of Measure

- A.** Press the "ON/UP" button to power the scale on.
- B.** Waiting for "0.0"LB or "0.0" KG to appear on the display.
- C.** Press "KG/LB/BMI" button, the scale will show your selected mode.
- D.** Press and hold the "KG/LB/BMI" button approximately 20 seconds until the unit of measure begins to flash three times and selected mode will be locked.
- E.** Repeat step D to change weighing model to a different unit of measure as the default.

Releasing the Lock of the Unit of Measure

- A.** Repeat 3 times for a total of 60 seconds
 - a.** press and hold "KG/LB/BMI" button approximately 20 seconds until the unit of measure flashes 3 times.
- B.** If unit of measure is still locked, repeat step A.

Special Features

Auto Shut-Off

A. Scale will automatically turn off after approximately 2 minutes of inactivity.

Cancelling Auto Shut-Off

A. Press and hold "KG/LB/BMI" button, press "ON/UP" button, display will show "A-OF", then, return "0.0", The scale will remain on until manually turned off.

Manually turned off

A. Press "OFF/DOWN" button 3 seconds.

Understanding Messaging

Display Code	Meaning of Code
"0000"	The weight capacity has been exceeded.
" -3.0 "	Minus weight, to adjust press "ZERO/HOLD".
" batt "	Blinking means the battery is low.

Specifications

Capacity	550 lbs
Remote Head Dimensions	5" x 3 1/4"
Platform Dimensions	12" x 12.5" x 2"
Power Source	4.5 Volt battery or 110V
AC Adapter Output	4.5V DC 200m

Compliance

This equipment has been tested and found to comply with the limits for a Class A digital device, pursuant to part 15 of the FCC Rules. These limits are designed to provide reasonable protection against harmful interference when the equipment is operated in a commercial environment. This equipment generates, uses, and can radiate radio frequency energy and, if not installed and used in accordance with the instruction manual, may cause harmful interference to radio communications. Operation of this equipment in a residential area may cause harmful interference in which case the user will be required to correct the interference at his or her own expense.

Care and Cleaning

PROTECT SCALE FROM: SHOCK, OVERLOAD, LIQUID SPILLS, EXTREME TEMPERATURES, OTHER ABUSES.

Preserve the finish of the scale by wiping only with damp, soft cloth and mild, nonabrasive detergent.

Warranty

1. Viva Comfort (the "Company" or "Tiger Companies") warrants to the purchaser that the product will be free from defects in workmanship and materials for a period of 1 year from the date of purchase. The warranty period is not extended if we repair, replace, exchange, or provide a refund for the product (as determined in our sole discretion). We may change the availability of this limited warranty at our discretion, but any changes will not be retroactive.
2. These warranties are not assignable or transferable to any other person, including, without limitation, any subsequent owner or other transferee of the product.
3. This Warranty does not apply to: (a) damage caused by misuse, tampering, abuse, neglect, or accident; (b) damage caused by improper installation, modification, or service; (c) alteration of the serial number; or (d) use that violates the instructions furnished by the Company will void this warranty.
4. The sole responsibility of the Company shall be limited to (a) the repair or replacement (in its sole discretion) of any component of the product which fails to conform to this; (b) a refund the purchase price of such product (in its sole discretion), at no cost to the purchaser for the period of the warranty, or (c) an exchange for a similar product, comparable in function and price.
5. Contact the Company directly at 1-(800)-805-1790 to obtain service under this warranty. If it becomes applicable to send a defective product to the Company, a Return Authorization Number must first be obtained from the Company. In order to obtain service under this warranty, purchaser may be required to provide the Company with the following items (a) proof of purchase, (b) photographs and or videos (of the damage, and (c) a written testimonial describing the defect.
6. Products shipped without prior Return Authorization and Return Authorization Number may not be accepted, and the Company will not be responsible for their disposition and/or cost of return to the owner.
7. The Company will not assume any responsibility for any loss or damage incurred in shipping and or delivery.
8. The product(s) must be returned within 14 calendar days of receiving the return authorization from the Company and must include the original proof of purchase for the warranty to be honored.
9. Any implied warranties that the purchaser may have are limited to the duration of the warranties described above. There are no further warranties that extend or apply beyond the face hereof, and the Company expressly disclaims and excludes any and all warranties of merchantability or fitness for a particular purpose. Some states do not allow limitations on how long an implied warranty lasts, so the above limitation may not apply to you.
10. THE REMEDIES DESCRIBED ABOVE ARE YOUR SOLE AND EXCLUSIVE REMEDIES AND THE COMPANY'S ENTIRE LIABILITY FOR ANY BREACH OF THIS LIMITED WARRANTY. OUR LIABILITY SHALL UNDER NO CIRCUMSTANCES EXCEED THE ACTUAL AMOUNT PAID BY YOU FOR THE DEFECTIVE PRODUCT, NOR SHALL WE UNDER ANY CIRCUMSTANCES BE LIABLE FOR ANY CONSEQUENTIAL, INCIDENTAL, SPECIAL OR PUNITIVE DAMAGES OR LOSSES, WHETHER DIRECT OR INDIRECT. SOME STATES DO NOT ALLOW THE EXCLUSION OR LIMITATIONS OF INCIDENTAL OR CONSEQUENTIAL DAMAGES, SO THE LIMITATION MAY NOT APPLY TO YOU.
11. This warranty gives you specific legal rights, and you may also have additional rights which vary from state to state.

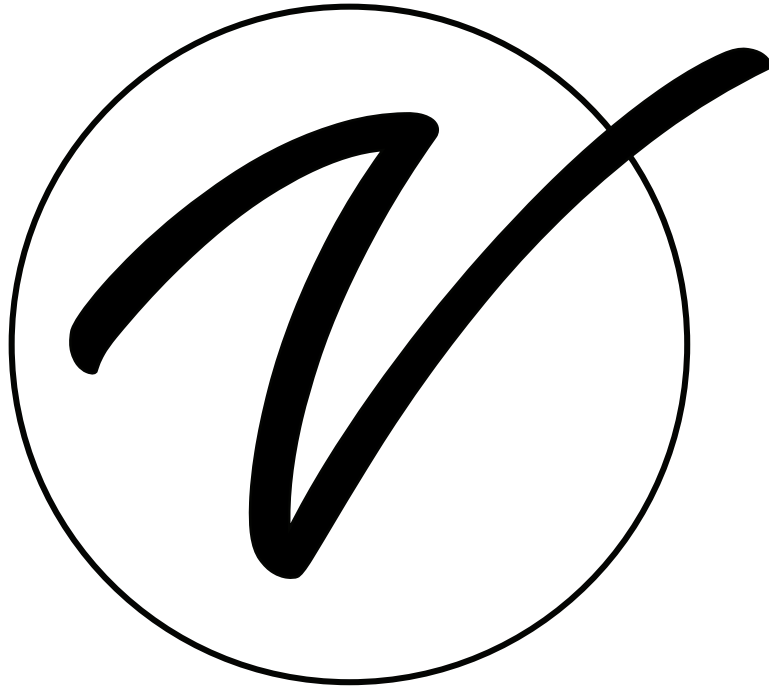

ADIME904-06

© 2024 Viva Comfort

vivacomfort.com