

BD Veritor™ System for Rapid Detection of Flu A+B

Liquid Nasopharyngeal Wash/Aspirate and Swab in Transport Media Samples _{Rx} Only

Read the complete test procedure, including recommended QC procedures, before performing the test. Refer to the package insert for complete information about the test.

For Questions and Technical Support call 1-800-638-8663.

I. Sample preparation steps 1-5 are shared by all instrument configurations:

- 1** Gather materials and label with specimen ID

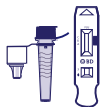

- 2** Remove cap from **Reagent C** tube



- 3** Add 300 µL of liquid sample



- 4** Close dispensing tube



- 5** Vortex



II. Before continuing to step 6, choose from the instrument and work flow configurations below:

A Reader or Analyzer in Analyze Now mode

- 6** Add 3 drops of the processed sample to the device.

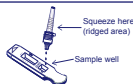

- 7** Time test development for 10 minutes.



- 8** Power on instrument with a **single click** and insert device to read when prompted.



- 9** Record result and remove device.

B Analyzer in Walk Away mode



- 6** Click once to power on, wait for prompt then **double-click** to start WalkAway mode.

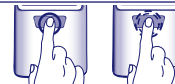

- 7** Add 3 drops of the processed sample to the device.



- 8** Insert device to start timing and analysis. **Do not touch/keep level.**



- 9** Record result and remove device - Analyzer returns to Analyze Now mode.

SPECIMEN COLLECTION AND HANDLING

Freshly collected specimens should be processed and tested immediately. If necessary, specimens may be stored at 2–8 °C for up to 72 hours but specimens must be warmed to room temperature before testing. For washes/aspirates, sample volumes of 1 to 3 mL are recommended. For swab specimens in transport media, a minimal dilution of specimen is preferred and use of 1 mL or less of transport media is suggested for optimal test performance. It is essential that correct specimen collection and preparation methods be followed. Do not centrifuge specimens prior to use, as the removal of cellular material may adversely affect test sensitivity. Specimens obtained early in the course of the illness will contain the highest viral titers.

For *in vitro* Diagnostic use.

Do NOT read test results visually. The BD Veritor System Instrument (purchased separately) must be used for interpretation of all test results. Refer to table at right.

Display	Interpretation
FLU A: + FLU B: -	Positive Test for Flu A (influenza A antigen present)
FLU A: - FLU B: +	Positive Test for Flu B (influenza B antigen present)
FLU A: - FLU B: -	Negative Test for Flu A and Flu B (no antigen detected)
RESULT INVALID	Result Invalid
POSITIVE CONTROL INVALID	Test Invalid. Repeat the test.
NEGATIVE CONTROL INVALID	Test Invalid. Repeat the test.

BD Veritor™ System for Rapid Detection of Flu A+B

Liquid Nasopharyngeal Wash/Aspirate and Swab in Transport Media Samples R_x Only

With the Addition of an Optional InfoScan or InfoSync module

I. Sample preparation steps 1-5 are shared by all instrument configurations:

- 1** Gather materials and label with specimen ID 
- 2** Remove cap from Reagent C tube 
- 3** Add 300 μ L of liquid sample 
- 4** Close dispensing tube 
- 5** Vortex 

II. Before continuing to step 6, choose from the work flow configurations below:

C  Analyzer in **Analyze Now mode + InfoScan/Sync**

6 Add 3 drops of the processed sample to the device. 

7 Time test development for 10 minutes. 

8 Power on with a **single click** and insert device to read when prompted. 

9 Scan required bar codes to start analysis. 

10 Record result and remove device.

D  Analyzer in **Walk Away mode + InfoScan/Sync** 

6 Click once to power on, wait for prompt then **double-click** to start WalkAway mode. 

7 Scan required bar codes. 

8 Add 3 drops of the processed sample to the device. 

9 Insert device to start timing and analysis. **Do not touch/keep level.** 

10 Record result and remove device - Analyzer returns to Analyze Now mode.

For *in vitro* Diagnostic use.

Do NOT read test results visually. The BD Veritor System Instrument (purchased separately) must be used for interpretation of all test results. Refer to table at right.

Handle all specimens and materials as if capable of transmitting infectious agents.

Dispose of used materials as biohazardous waste according to federal, state and local requirements.

Ensure ALL components are at room temperature (15–30 °C) when running the test.

 Becton, Dickinson and Company
7 Loveton Circle
Sparks, MD 21152 USA



8091615(01)
2016-04

Display	Interpretation
FLU A: + FLU B: -	Positive Test for Flu A (influenza A antigen present)
FLU A: - FLU B: +	Positive Test for Flu B (influenza B antigen present)
FLU A: - FLU B: -	Negative Test for Flu A and Flu B (no antigen detected)
RESULT INVALID	Result Invalid
POSITIVE CONTROL INVALID	Test Invalid. Repeat the test.
NEGATIVE CONTROL INVALID	Test Invalid. Repeat the test.