

BD Microtainer® MAP Microtube for Automated Process

Capillary Blood Collection Methods

Performing a Heel Stick

CLSI H4-A6 Recommended Guidelines*:
1. Warming the infant's heel is essential for pH and Blood Gases.

2. Warming the heel increases arterial blood flow to the site up to seven-fold without burning the skin.

3. Temperature of warming device should be no higher than 42° C. Warming should be three to five minutes.

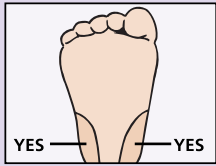

Select a site identified in the shaded area above.

Cleanse site thoroughly with alcohol. (70/30 by volume, 70%).

Allow skin to air dry.

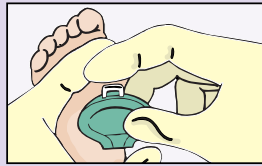

With a gloved hand, place the **BD Microtainer® Quikheel™ Lancet** against the site with the Quikheel logo facing you.

Place the blade slot area securely against the heel.

The incision can be placed at a 90° angle to the length of the foot or parallel to the length of the foot.

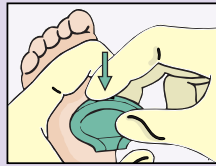

Firmly and completely depress the trigger with your index finger.



After triggering the lancet, remove the lancet and discard it into a biohazard sharps container.

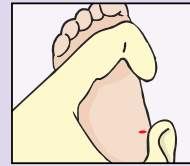

Gently wipe away the first drop of blood with clean, dry gauze pad.

Apply gentle pressure with the thumb and ease intermittently as drops of blood form.

Be sure to apply pressure such that the incision is opened.

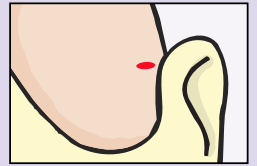

Filling BD Microtainer® Tubes with BD Microgard™ Closure

Obtain necessary supplies.
Confirm the identity of the newborn.
Follow universal precautions.

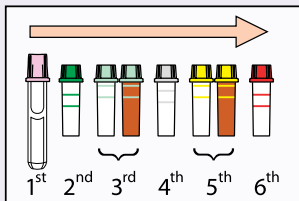

Conduct Heel Stick as outlined in the "Performing a Heel Stick" section above.

The order of draw for microcollection differs from that of venipuncture.

If multiple specimens are to be collected, including EDTA specimens, the EDTA specimen is collected first to ensure adequate volume and accurate hematology test results.

Additive specimens are collected next.

Specimens requiring serum are collected last.

Follow twist assist cap removal instructions above.

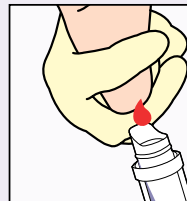
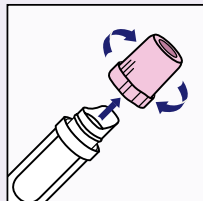

Collect the specimen with the Microtainer tube by allowing the blood to run into the collection funnel while holding at a 30-45° angle.

Ensure that the tube is not scraped over the puncture site.

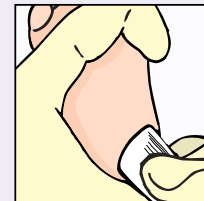

After blood has been collected from the heel of the newborn, the foot should be elevated above the body.

A clean gauze pad should be pressed against the puncture site until bleeding stops.

It is not advisable to apply adhesive bandages over skin puncture sites on newborns.

Invert the BD Microtainer® MAP Microtube for Automated Process according to label instructions. (**K2EDTA** – 8x)

Mix all other Microtainer Tubes with Microgard Closures with the following inversions:

PST – 10x

SST – 5x

Glucose – 10x

Serum – 0x

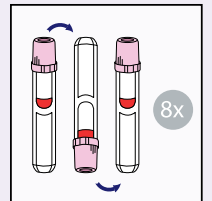

BD Microtainer® Product Offerings

BD Microtainer® MAP Microtube for Automated Process

Reference Number	Description	Packaging Box/Case Quantities
363706	1.0 mg K2EDTA Additive, 13 x 75 mm, Volume 250-500 µL	50/200



BD Microtainer® Quikheel™ Lancets

Reference Number	Width and Depth (mm)	Blood Volume	Color	Packaging Box/Case Quantities
368100	1.75 x 0.85	Low Flow (Preemie)	Pink	50/200
368101	2.50 x 1.00	High Flow (Infant)	Teal	50/200



For more information, call or visit us online:
BD Global Technical Services at **1.800.631.0174** (USA only)
Canadian customers: **1.866.979.9408**
Or submit an inquiry at www.bd.com/vacutainer/contact

BD Customer Service at **1.888.237.2762**
www.bd.com/vacutainer/MAP

BD Microtainer® MAP Microtube for Automated Process

Capillary Blood Collection Methods

Performing a Fingertick Collection

Warm the site.

Use a warm, moist towel or other appropriate warming device (not more than 42°C) for three to five minutes.

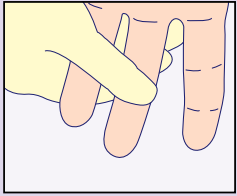

Select the site.

The patient should be sitting or lying down. Have patient hold their hand in a downward position, allowing gravity to help increase blood supply to the hand.

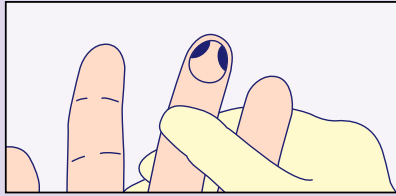

Select finger: middle or ring finger is preferable. Identify the desired puncture site (shaded area) and make sure it is properly cleansed with 70% alcohol according to your facility's established procedures.

The site must be allowed to air dry in order to provide effective disinfection and to prevent possible hemolysis or erroneous results from residual alcohol.

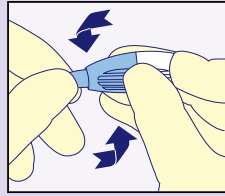

Twist off tab to break the seal and discard.

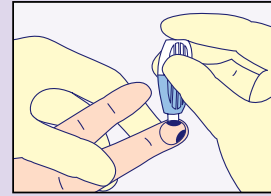

Position the safety lancet firmly against the puncture site as illustrated.

Hold safety lancet between fingers.

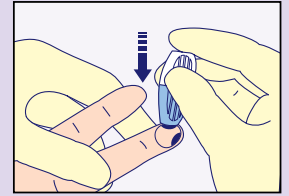

To activate, **press safety lancet firmly against the puncture site**. Do not remove the device from the site until an audible click is heard.

Discard used safety lancet into an approved sharps container. Collect the specimen.

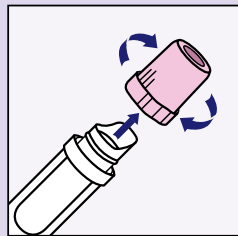
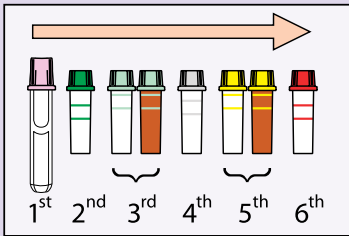

The order of draw for microcollection differs from that of venipuncture.

If multiple specimens are to be collected, including EDTA specimens, the EDTA specimen is collected first to ensure adequate volume and accurate hematology test results.

Additive specimens are collected next.

Specimens requiring serum are collected last.

Follow twist assist cap removal instructions above.

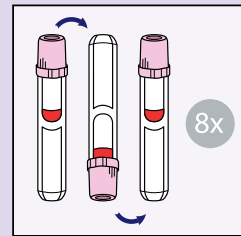
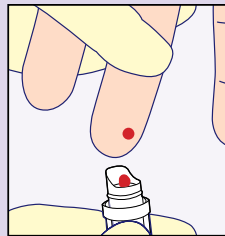

Gently apply intermittent pressure along finger capillaries up to the puncture site. Hold hand below elbow level to obtain the required blood volume. Strong repetitive pressure (milking) must be avoided.

Wipe away the first drop of blood with a clean dry gauze pad.

Turn the patient's hand palm down.

Position the BD Microtainer MAP Microtube for Automated Process directly beneath the puncture site. Apply gentle, intermittent pressure along finger capillaries to allow them to refill with blood and to help ensure continuous blood flow. Apply gentle pressure at the ends of the puncture site, opening the puncture site slightly, to maximize blood flow. Ensure that the tube is not scraped over the puncture site. Invert tube according to label instructions.

Complete the procedure. Wipe the site dry and apply direct pressure with a clean gauze pad until the bleeding has stopped. Dispose of all used materials according to your facility's established procedures. Label the tubes and transport them to the lab for processing.

BD Microtainer® Product Offerings

BD Microtainer® MAP Microtube for Automated Process

Reference Number	Description	Packaging Box/Case Quantities
363706	K2EDTA Additive 1.0 mg, 13 x 75 mm, Volume 250-500 µL	50/200



BD Microtainer® Contact-Activated Lancet

Reference Number	Width and Depth (mm)	Blood Volume	Color	Packaging Box/Case Quantities
366594	1.5 mm x 2.0	High Flow	Blue	200/2000



For more information, call or visit us online:
BD Global Technical Services at **1.800.631.0174** (USA only)
Canadian customers: **1.866.979.9408**
Or submit an inquiry at www.bd.com/vacutainer/contact

BD Customer Service at **1.888.237.2762**
www.bd.com/vacutainer/MAP

CAUTION: Handle all biologic samples and blood collection "sharps" (lancets, needles, luer adapters, and blood collection sets) in accordance with the policies and procedures of your facility. Obtain appropriate medical attention in the event of any exposure to biologic samples (e.g., through a puncture injury) since samples may transmit viral hepatitis, HIV (AIDS), or other infectious diseases. Utilize any safety-engineered feature if the blood collection device provides one. Discard all blood collection "sharps" into biohazard containers approved for their disposal.

BD, BD Logo and all other trademarks are property of Becton, Dickinson and Company.
© 2010 BD VS8144



BD Diagnostics
Preanalytical Systems
1 Becton Drive
Franklin Lakes, NJ 07417