

**BD**Indispensable to  
human health

# BD Introsyte™ Autoguard™ and BD Introsyte™ -N Autoguard™ Shielded Introducers

## QUICK REFERENCE CARD

1

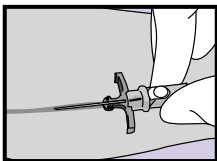

### Venipuncture

- Perform venipuncture using a low angle
- Observe flashback behind activation button
- Lower insertion angle and proceed slightly to ensure both the needle and sheath are in the vessel
- Thread introducer sheath at least 1/8 inch off the needle into the vessel

2

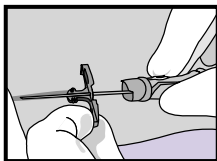

### Retract Needle

- Release tourniquet
- Support Introducer to avoid displacement
- Apply digital pressure above the introducer to minimize blood flow
- Press the white activation button and the needle will retract into the shielded barrel
- Dispose of the shielded needle in an appropriate sharps container

3

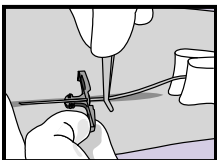

### Insert Catheter

- Grasp the catheter close to the distal tip and begin advancing it through the opening in the introducer sheath

# BD Introsyte™ Autoguard™ and BD Introsyte™-N Autoguard™ Shielded Introducers

## QUICK REFERENCE CARD

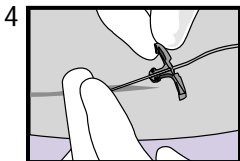

### Withdraw Introducer

- Withdraw the introducer sheath after the catheter has been inserted at least 10cms
- Stabilize the catheter by applying digital pressure above the introducer sheath
- Withdraw the introducer sheath from the vein and away from the site

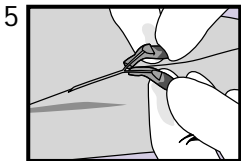

### Split Introducer Sheath and Peel Away

- Rock introducer sheath wings back and forth and split
- Peel introducer sheath away from catheter using care to maintain catheter position

### Things to Remember:

- KEEP FINGERS AWAY FROM ACTIVATION BUTTON
- Low insertion angle
- Make sure introducer sheath is at least 1/8 inch off the needle prior to button activation
- Digital pressure above introducer sheath tip
- Observe for flashback behind activation button
- Have catheter ready for insertion prior to button activation
- Do not recannulate
- Do not place excessive pressure on introducer sheath.
- Always retract needle prior to withdrawal from the introducer sheath
- Always handle all sharps with caution. Place all shielded and unshielded needles in appropriate sharps container
- Report all needlestick injuries and follow established protocols