

**Health o meter<sup>®</sup>**  
**P r o f e s s i o n a l**

## 499KL / 499KG Waist-High Digital Beam Scale



Equipped with  
Everlock<sup>®</sup>

ISO13485:2016  
CERTIFIED

ISO 9001:2015  
CERTIFIED



E112697

## User Instructions



**PELSTAR<sup>®</sup>, LLC** 9500 West 55th St. McCook, IL 60525-7110 USA

Health o meter<sup>®</sup> Professional 499KL  
Health o meter<sup>®</sup> Professional 499KG

[www.homscapes.com](http://www.homscapes.com)

© Pelstar, LLC 2020

**weigh**easier<sup>®</sup>

Thank you for purchasing this Health o meter® Professional product. Please read this manual carefully, and keep it for easy reference or training.

## TABLE OF CONTENTS

|   |    |
|---|----|
| Cautions and Warnings .....                                   | 3  |
| Specifications / Definitions of Symbols.....                  | 4  |
| Certifications / Connectivity / Disposal .....                | 5  |
| Assembly Instructions .....                                   | 6  |
| Powering the Scale .....                                      | 11 |
| Set Up Instructions.....                                      | 12 |
| Operating Instructions .....                                  | 15 |
| Assembly Instructions for Optional Height Rod (499KLROD)..... | 19 |
| Height Measurement Instructions.....                          | 20 |
| Maintenance.....  | 22 |
| Calibration .....   | 23 |
| Troubleshooting .....   | 24 |
| Warranty.....   | 25 |

**Note:** This scale has been factory calibrated, and does not require calibration prior to use.

Please register your scale for warranty coverage at:  
[www.homscales.com/product-support/technical-support/product-warranty-registration](http://www.homscales.com/product-support/technical-support/product-warranty-registration)

For User Instructions updates and revisions please go to:  
[www.homscales.com](http://www.homscales.com)

# CAUTIONS AND WARNINGS

## **INTENDED USE**

This Health o meter® Professional scale is intended to be used in a professional medical environment by trained medical staff. This product was designed to weigh patients who are safely positioned and standing on the platform. Do not modify the product or use it for anything other than its intended purpose.

**To prevent patient/caregiver injury or damage to your scale, please follow the instructions in this user manual very carefully.**

- Do not exceed the weight capacity specified for this scale.
- For accurate weighing, this scale must be placed on a flat, stable surface.
- For accurate weighing, verify before each use the proper operation according to the procedure described in this manual.
- Do not use in the presence of flammable or explosive materials.
- If the scale becomes damaged, it should not be operated until properly serviced.
- Do not transport the scale with a patient or object on the scale.
- Do not wheel or pull the scale down stairs, doing so may damage internal parts.
- Ensure that the AC adapter and scale do not come in contact with liquids, excessive temperature, or excessive humidity.
- Exercise caution when assembling the scale column so as to not pinch the load cell connector cable.

## **Patient/caregiver safety**

- This scale is designed for static weighing of patients only. No scale should be used for patient transfer.
- Patient should wear socks or other form of lightweight foot covering during weighing event.
- To prevent patient injury, the patient must be attended to throughout the entire weighing event. Caregivers should ensure that the patient is stable and provide support as needed when getting onto and off of the scale.

## **When operating the scale with the AC adapter:**

- Operate this scale exclusively with the AC adapter provided by Health o meter® Professional. Use of an unspecified adapter will void the warranty, and can pose a serious safety hazard.
- For use with AC adapter model ADPT30 (not included)
- Prior to using this scale, inspect the AC adapter cord for cracking / fraying, or for broken / bent plug prongs.
- Prior to using this scale, ensure that the AC adapter is plugged into an outlet with the rated voltage appropriate for operation.
- Ensure that the AC outlet is wired to a circuit breaker or other protected power source.
- Unplug the AC adapter, and carefully store both the adapter and adapter cord before moving the scale.
- Operating this scale at voltages and frequencies other than specified can damage the equipment and will void the warranty.

## **When operating the scale with batteries:**

- If the display indicates that the batteries are low, replace the batteries or switch to the AC adapter as soon as possible.
- When replacing / inserting batteries, be sure to use all new batteries.

This equipment has been tested and found to comply with the EMC limits for the Medical Device Directive 93/42/EEC (EN 55011 Class A and EN 60601-1-2). These limits are designed to provide reasonable protection against harmful interference in a typical medical installation. The equipment generates, uses and may radiate radio frequency energy and, if not installed and used in accordance with these instructions, may cause interference to other devices in the vicinity. There is no guarantee that interference will not occur in a particular installation. If this equipment does cause harmful interference with other devices, which can be determined by turning the equipment off and on, the user is encouraged to try to eliminate the interference by one or more of the following measures:

- Reorient or relocate the receiving device.
- Increase the separation between the equipment.
- Plug the equipment into an outlet on a circuit different from that to which the other device(s) is connected.
- Consult Customer Service or a field service technician for help.

**In no event whatsoever shall Pelstar, LLC be liable for damages or injuries arising from or connected with the assembly, use, or misuse of its products.**

# SPECIFICATIONS

## General

The model 499KL / 499KG waist high digital beam scale uses highly sophisticated microprocessor technology. This precision scale is designed to provide accurate, reliable and repeatable weight measurements. In addition, each scale is designed to provide the user with features that make the weighing process simple, fast, and convenient.

This scale uses motion-sensing weighing technology to determine the weight of a moving patient.

On the 499KL, weight can be displayed in pounds (lb) or in kilograms (kg). On the 499KG weight is displayed in kilograms only. **This scale can be powered using AC adapter (not included) or by 6 - AA batteries (included).**

## Scale Specifications

|                         |   |   |
|-------------------------|---|---|
| Capacity and Resolution | 499KL: 550 lb x 0.2 lb (250 kg x 0.1 kg)<br>499KG: 250 kg x 0.1 kg  |   |
| Power Requirements      | Adapter Model No. UE15WCP1-090050SPA, Part No. UE160714HKKK1-P<br>Adapter Model No. UES06WNCP-090050SPA, Part No. UE190716HKSH1RM<br>Adapter Model No. / Part No. RHD10W090050<br>(Not Included)<br>Input: 100-240VAC, 50/60Hz, 500mA<br>Output: 9.0V $\overline{---}$ 0.5A<br><br>Or 6 AA Batteries (included) |   |
| Environmental           | Operating temperatures: 50°F to 104°F (10°C to 40°C)<br>Storage temperatures: 32°F to 122°F (0°C to 50°C)<br>Maximum Humidity: 95% RH   |   |
| Physical Dimensions     | <b>Scale<br/>(Overall Dimensions)</b><br>Width: 14-1/8" (359 mm)<br>Depth: 21-1/8" (537 mm)<br>Height: 43-1/2" (1105 mm)<br>Weight: 20 lb (9 kg)  | <b>Platform<br/>(Standing Area)</b><br>Width: 13-3/4" (349 mm)<br>Depth: 16-1/2" (419 mm)<br>Height: 2-3/8" (60 mm) |

# DEFINITION OF SYMBOLS



Attention, Consult Accompanying Documents



Temperature range  
(10°C to 40°C / 50°F to 104°F)





Type B Applied Parts



AC to DC power supply

# CERTIFICATIONS / CONNECTIVITY / DISPOSAL

## Certification Descriptions

|   |   |
|---|---|
|  | <p>Pelstar, LLC has been officially certified as the manufacturer of Health o meter® Professional medical devices. The Pelstar, LLC quality assurance system covers the development, production, sales and service of medical scales and measuring systems.</p> |
|  | <p>Complies with:<br/>ANSI/AAMI ES60601-1 (2005) + AMD 1 (2012), CAN/CSA-C22.2 No. 60601-1 (2014), IEC 60601-1-6 (2010) + AMD 1 (2013)</p>  |

Health o meter® Professional scales are manufactured in FDA-registered factories.

## Connectivity Information

To enable reliable transmission of weight, height, and Body Mass Index (BMI) data, this scale is designed to connect to a computer, monitor, or other electronic device via USB or optional Pelstar® wireless technology. This connectivity helps minimize a source of potential medical errors caused by incorrectly copying and then recording patient data. For more information regarding how to connect the scale to other electronic devices, please contact Health o meter® Professional Scales Technical Support, available during normal business hours at 1-800-638-3722.

## Scale Disposal



This Health o meter® Professional scale must be disposed of properly as electronic waste. Follow the national, regional or local regulations that apply to you for disposal of electronic waste or batteries. Do not dispose of this device in the domestic waste stream.

# ASSEMBLY INSTRUCTIONS

## Before Assembly

Each 499KL / 499KG waist high digital beam scale is shipped disassembled in one carton. Carefully inspect the carton for shipping damage before unpacking. If damage is found, contact your shipper or a Health o meter® Professional representative immediately at 1-800-815-6615. Claims must be filed with the shipper as soon as possible after receipt of the package. The following information details what you will find inside the main carton as you unpack the parts for assembly.

To prevent scratching any components, carefully remove each assembly from the carton and unwrap the packing materials. Set the carton aside for storage. To avoid damaging the scale parts when unpacking, do not use a box cutter, knife, scissors, or any sharp object to open the protective inner packaging.

## Parts List

### Carton

- (1) Scale platform (C)
- (1) Upper column w/ display assembly (Column A)
- (1) Lower column (Column B)
- (6) AA batteries
- (1) User instructions

## Tools Required

Phillips head screwdriver (not included)

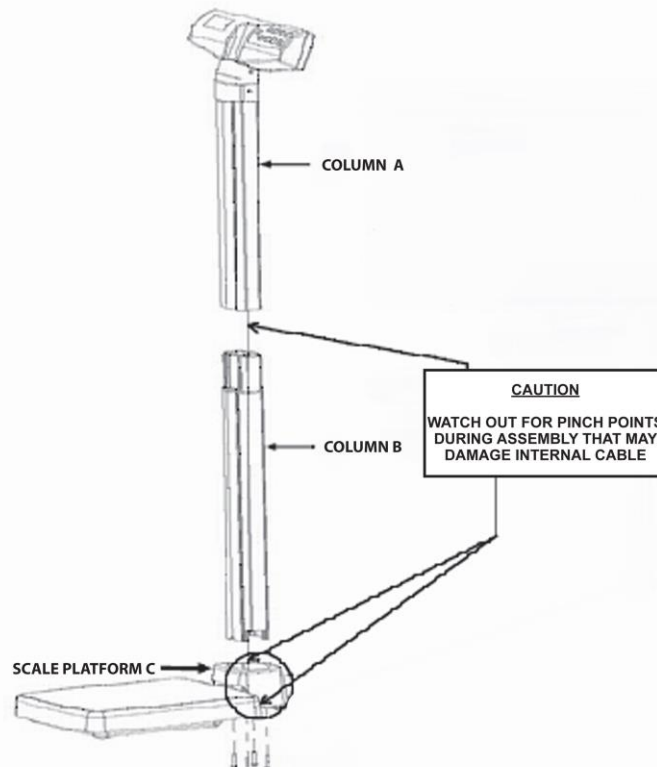

## ASSEMBLY INSTRUCTIONS (CONTINUED)

1. Carefully remove the scale platform and columns A and B from the carton. Place the scale platform and columns on a flat, level, and dry surface. Remove the 4 column mounting screws and washers from the bottom of column B and set aside for assembly step 7.

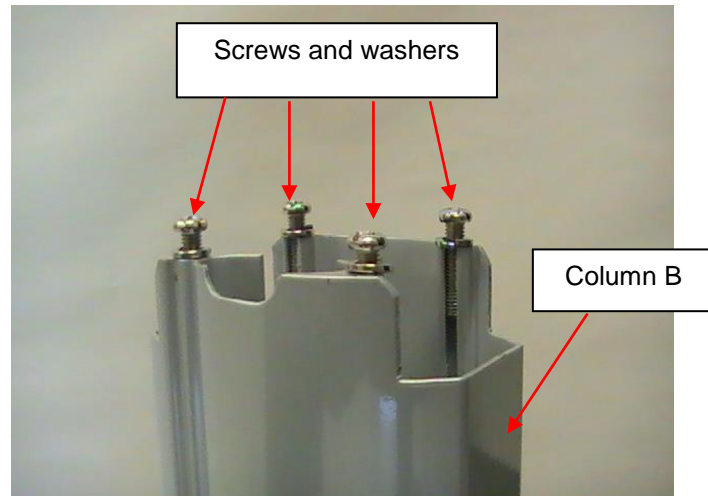

2. Remove the black bracket from scale platform C. Read the "Attention" label then remove it from the bracket. Place the bracket on the bottom of Column B with the adapter jack arrow sticker pointing towards the bottom of the column.

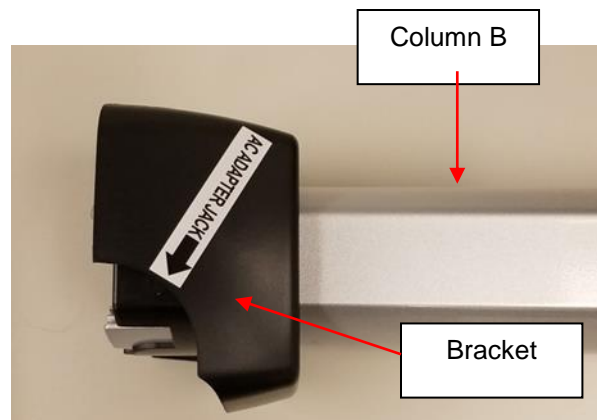

# ASSEMBLY INSTRUCTIONS (CONTINUED)

3. Locate the load cell connector cable inside column A. While holding column B, slide the cable through the center opening at the top of column B. Push the cable all the way through Column B until the plug reaches the bottom of the column.

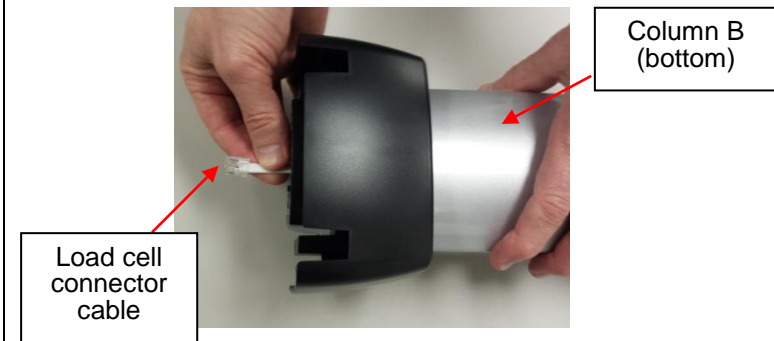
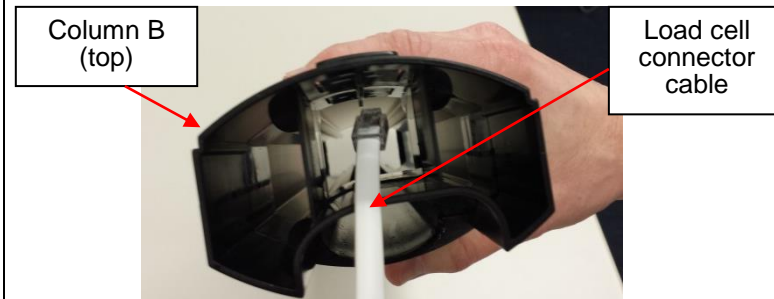
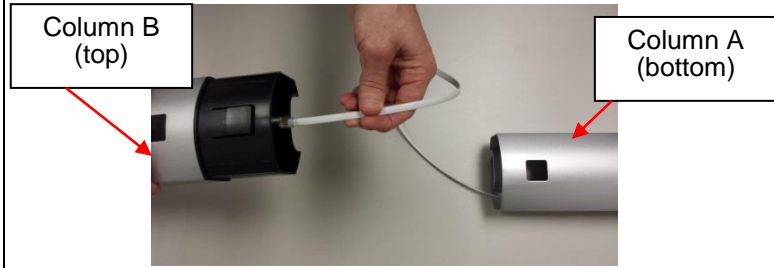

4. Align column A and column B. Notches are located at the bottom of column A and the top of column B. Snap the locking tab into place. Ensure that the locking tab is locked securely into place. **Note: When aligning and locking the columns, use caution not to pinch the load cell connector cable.**

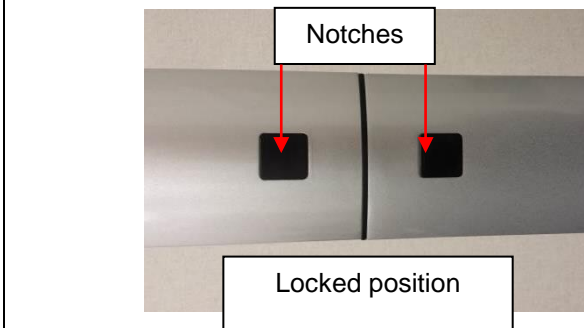
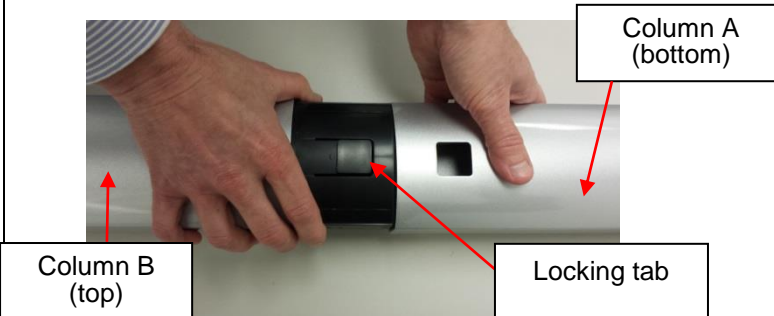



## ASSEMBLY INSTRUCTIONS (CONTINUED)

5. Place scale platform C on its side and place Column B on its side, perpendicular to the platform. The front of the display head on Column A should be facing forward and above scale platform C.



6. Carefully pull the cable connector from the bottom of Column B and plug into the RJ jack on scale platform C. **Caution: Once connected, keep a firm grip on the columns to ensure the load cell connector cable is not pulled out from the RJ jack. This cable connects the load cells to the display head and must be entirely plugged in for the scale to function properly.**

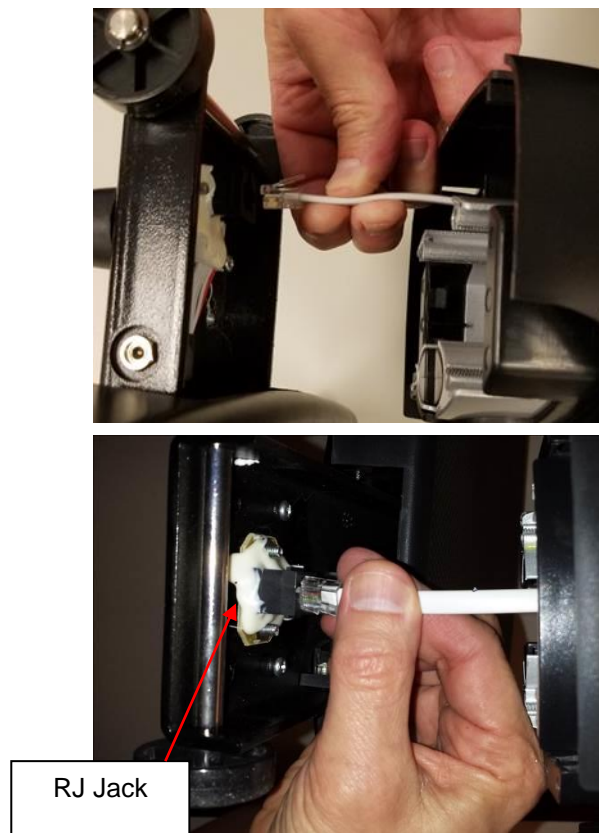

## ASSEMBLY INSTRUCTIONS (CONTINUED)

7. Position and secure the connected columns A and B to scale platform C. Locate the 4 column mounting screws previously removed in step 2. Ensure that washers are located between the screw heads and the scale platform C screw holes. Insert the 4 screws through the bottom of scale platform C screw holes and into Column B. Using a Phillips head screwdriver, tighten the screws to secure Column B to the base of platform C.



# POWERING THE SCALE

## Powering the Scale – Inserting Batteries

1. With a Phillips head screwdriver remove the screw from the battery compartment cover located on the back of the display. Remove the battery cover by pressing downward on the locking tab.



2. Replace or install 6 new AA batteries. Health o meter® Professional recommends using an alkaline or lithium battery, rated for 130°F (54°C) operation. Do not use zinc-carbon batteries.
3. Re-attach the battery cover to the display assembly.
4. Ensure all objects are removed from the scale's platform, and then press the  button to turn the scale on. The display will show a version number, followed by dashes, then "0.0". LB (Pounds) is the default weight measuring unit upon initial set-up/assembly. Press the **UNIT** button to select your desired weight mode (LB or KG). (499KL only)

**Note:** If "LoBat" appears on the display, it indicates that the battery power is low. It does NOT indicate a problem with the weight measurement.

**Warning:** If the scale will not be used for some time, remove the batteries to avoid a safety hazard. Disposal of batteries must be performed in accordance with the prevailing national, regional or local regulations that apply to you.

## Optional AC Adapter

1. Connect the AC adapter (not included) into the adapter jack on the scale platform **C**.

**Warning:** To avoid a safety hazard, use only a Health o meter® Professional AC adapter.





2. Plug the scale's AC adapter into the power source.
3. When the AC adapter is disconnected from the scale, the scale will switch to battery power if batteries are installed.

**Caution:** Always plug the AC adapter into the scale first, then into the power source/wall outlet.

## Power Source Icons

**AC Icon:** The AC icon will display when the scale is being powered by the AC adapter.

**Battery Icon:**

1. The battery icon will display when the scale is being powered by batteries.
2. The battery icon indicates the level of battery power remaining.  
When all three segments are full, this indicates full battery power. 
3. If the battery icon is empty, replace the batteries.  If the batteries are completely depleted the display will flash "LoBat" and the scale will power off.

# SET UP INSTRUCTIONS

To enter the Options mode, push and hold the **ENTER** button while pressing and releasing the  button.



## Auto Off Function



When powering the scale via the AC adapter, the display can be set to power off after a period of inactivity. The Auto Off default setting is “disabled”. Follow this procedure to enable or disable the Auto Off function. **Note:** When powering the scale via batteries, the Auto Off function is automatically enabled.

## Enable / Disable Auto Off

1. While the scale is turned off, press and hold the **ENTER** button then press and release the  button. Hold the **ENTER** button until “AOF=d” or “AOF=E” appears on the display, then release. Press the **ENTER** button again to change the setting.  
AOF=d Disables the Auto Off function  
AOF=E Enables the Auto Off function
2. Press **CLEAR/REWEIGH** to save your selection and exit the Options mode.
3. The scale will restart. The display will show “UEr”, followed by a version number, and then dashes. When the display shows “0.0” the scale is ready to use.



## Setting Auto Off Time

When powering the scale via batteries or if Auto Off is Enabled for the AC adapter, the period of inactivity before the scale powers off can be set to a specific amount of time. The default setting for Auto Off time is 2 minutes. Follow this procedure to set the number of minutes of inactivity before power off.

1. While the scale is turned off, press and hold the **ENTER** button then press and release the  button. Hold the **ENTER** button until “AOF=d” or “AOF=E” appears on the display, then release. Use the  or  buttons to advance the display screen until “AFt” appears. Press the **ENTER** button to change the Auto Off time.  
AFt = 1 Scale will power off after 1 minute of inactivity  
AFt = 2 Scale will power off after 2 minutes of inactivity  
AFt = 3 Scale will power off after 3 minutes of inactivity
2. Choose the setting you prefer and press **CLEAR/REWEIGH** to save your selection and exit the Options mode.
3. The scale will restart. The display will show “UEr”, followed by a version number, and then dashes. When the display shows “0.0” the scale is ready to use.

## Setting Sound Options

The display can be set to stay silent or beep while operating the scale. The default setting for Sound is “enabled”. Follow this procedure to enable or disable sound.

1. While the scale is turned off, press and hold the **ENTER** button then press and release the  button. Hold the **ENTER** button until “AOF=d” or “AOF=E” appears on the display, then release. Use the  or  buttons to advance the display screen until “Snd” appears. Press the **ENTER** button to change the setting.  
Snd = E Enables sound so the scale beeps when keys are pressed.  
Snd = d Disables sound so the scale stays silent when keys are pressed.
2. Choose the setting you prefer and press **CLEAR/REWEIGH** to save your selection and exit the options mode.
3. The scale will restart. The display will show “UEr”, followed by a version number, and then dashes. When the display shows “0.0” the scale is ready to use.

## SET UP INSTRUCTIONS (CONTINUED)

### **Locking Unit of Measure (LB or KG)**

**(499KL only, this feature is not available on 499KG)**

The weight measuring unit (pounds / LB or kilograms / KG) can be locked to display weight only in the selected unit of measure. The unit of measure lock default setting is “unlocked”. Follow this procedure to lock the **UNIT** button. **Note:** If Everlock® is engaged, this feature will not appear in the Options mode.

1. While the scale is turned off, press and hold the **ENTER** button then press and release the  button. Hold the **ENTER** button until “AOF=d” or “AOF=E” appears on the display, then release. Use the **▲** or **▼** buttons to advance the display screen until “Unt” appears. Press the **ENTER** button to change the setting.  
Unt = U Allows the user to toggle weight measurement between LB and KG.  
Unt = L Locks the unit button so weight is only displayed in pounds (LB)  
Unt = G Locks the unit button so weight is only displayed in kilograms (KG)
2. Choose the setting you prefer and press **CLEAR/REWEIGH** to save your selection and exit the options mode.
3. The scale will restart. The display will show “UEr”, followed by a version number, and then dashes. When the display shows “0.0” the scale is ready to use.

### **Enabling Unit View with Unit of Measure Locked**

If the scale is locked per the instructions above, users can still view the alternate weight measuring unit by enabling the “Unit View” option. Enabling the “Unit View” option allows the user to press the **UNIT** button to briefly display the weight in the alternate weight measuring unit. After releasing the **UNIT** button the display will return to the locked weight measuring unit. The “Unit View” default setting is “Disable”. Follow this procedure to enable “Unit View” when the weight measuring unit is locked. **Note:** If Everlock® is enabled, this feature will not appear in the Options mode.

1. While the scale is turned off, press and hold the **ENTER** button then press and release the  button. Hold the **ENTER** button until “AOF=d” or “AOF=E” appears on the display, then release. Use the **▲** or **▼** buttons to advance the display screen until “UdP” appears. Press the **ENTER** button to change the setting.  
UdP = d Disables the **UNIT** button so it will not display the other weight measuring unit.  
UdP = E Allows the user to view the other weight measuring unit by holding down the **UNIT** button even if the weight measuring unit is locked. Enabling this function will only allow the user to view the other unit while pressing the **UNIT** button; it will not unlock the weight measuring unit.
2. Choose the setting you prefer and press **CLEAR/REWEIGH** to save your selection and exit the Options mode.
3. The scale will restart. The display will show “UEr”, followed by a version number, and then dashes. When the display shows “0.0” the scale is ready to use.

### **Setting Auto Zero**

This option allows the user to select whether the scale will re-set itself to ZERO each time it is powered up or whether it will use the zero reading from the last time it was zeroed. The auto zero default setting is “enabled” Follow this procedure to enable or disable this feature.

1. While the scale is turned off, press and hold the **ENTER** button then press and release the  button. Hold the **ENTER** button until “AOF=d” or “AOF=E” appears on the display, then release. Use the **▲** or **▼** buttons to advance the display screen until “PU2” appears. Press the **ENTER** button to change the setting.  
PU2 = d Disabling this feature means the scale does not attempt to find a zero when powered on, rather it will use the zero setting it had from its most recent use.  
Health o meter® Professional recommends that if the Disable option is selected, users should manually zero the scale before each weight measurement by

## SET UP INSTRUCTIONS (CONTINUED)

pressing **ZERO / TARE**. Users will see dashes on the screen as the scale is finding zero.

PU2 = E    Enabling this feature means the scale will zero itself when it is powered on. After each use, the scale will clear the weight of the patient and set itself back to the initial ZERO level it found on start-up. Health o meter<sup>®</sup> Professional recommends keeping this setting as Enable. Choose the setting you prefer and press **CLEAR/REWEIGH** to save your selection and exit the Options mode.

2. The scale will restart. The display will show “UEr”, followed by a version number, and then dashes. When the display shows “0.0” the scale is ready to use.

### **Everlock<sup>®</sup>**

**(499KL only, this feature is not available on 499KG)**

The Everlock<sup>®</sup> feature allows the measuring unit to be permanently locked on the scale, disabling the **UNIT** button. The Everlock<sup>®</sup> default setting is “disabled”. Follow this procedure to engage Everlock<sup>®</sup>.

**Warning: This lock is permanent and cannot be reversed.**

### **Notes:**

- Press **CLEAR/REWEIGH** at any time to exit the Everlock<sup>®</sup> procedure.
  - Once Everlock<sup>®</sup> is engaged the Unt and UdP options will no longer be displayed when scrolling through the Options menu.
  - There is no method to undo Everlock<sup>®</sup> without sending the scale back to the manufacturer.
1. While the scale is turned off, press and hold the **ENTER** button then press and release the  button. Hold the **ENTER** button until “AOF=d” or “AOF=E” appears on the display. Use the **▲** or **▼** buttons to advance the display screen until “ELC” appears. Press the **ENTER** button to change the setting.  
ELC = d    Default setting with Everlock<sup>®</sup> disabled.  
ELC = E    Engages Everlock<sup>®</sup>. Once this option is selected, the display will prompt you to begin the locking procedure. If this is desired, follow the instructions below.
  2. After Everlock<sup>®</sup> is selected, “PASS1” will appear on the display. This prompts the user to enter a password. Press the following keys in this sequence:  
**BMI, ENTER, ▼, ▲**
  3. If entered correctly, “ELC=L” (if scale was in LB mode) or “ELC=6” (if scale was in KG mode) will appear on the display.
  4. Use the **▼** and **▲** keys to toggle between (L) Pounds and (6) Kilograms. When the desired unit is displayed, press **ENTER** and “PASS2” will appear on the display.
  5. This will prompt the user to enter the second password. Press the following keys in this sequence:  
**▲, ▼, ENTER, BMI**
  6. If entered correctly, the scale will display “ELC = L” or “ELC = 6,” depending on the unit of measurement that was selected. Everlock<sup>®</sup> is now engaged.

# OPERATING INSTRUCTIONS



## Keypad

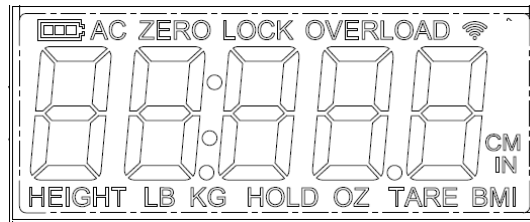

| Function  | Description  |
|---|--|
|  | Turns scale on and off. Also used when entering Calibration or Options mode.   |
| <b>HOLD/RLS/<br/>RECALL</b>   | Holds the displayed weight until the button is pressed again to release the value. Will recall the previously locked weight if pressed when nothing is on the scale.   |
| <b>UNIT</b>   | 499KL: Toggles between pounds (LB) and kilograms (KG). If weight measurement unit is locked, press and hold <b>UNIT</b> button to display other weight measurement unit. Note: Weight measurement will not toggle on 499KG or if Everlock® is engaged. |
| <b>BMI</b>  | Prompts entry of height data to calculate patient's Body Mass Index (BMI).   |
| <b>UP ▲</b>   | Increases height input (0.5 in / 0.5 cm increments) in BMI mode or weight in pre-tare mode. Also used to navigate Options.   |
| <b>ZERO/TARE</b>  | Zeroes out or tares the scale prior to a weighing.   |
| <b>CLEAR/<br/>REWEIGH</b>   | Exits out of a mode or process. Also allows for repeated weighing of the patient without requiring the patient to get off the scale.   |
| <b>ENTER/<br/>SELECT</b>  | Selects an option or value.  |
| <b>DOWN ▼</b>   | Decreases height input (0.5 in / 0.5 cm increments) in BMI mode or weight in pre-tare mode. Also used to navigate Options.   |

# OPERATING INSTRUCTIONS (CONTINUED)



| Icon  | Description   |
|---|---|
|    | Indicates scale is being powered by batteries. Also indicates level of battery power remaining.   |
| <b>AC</b>   | Indicates scale is being powered by AC adapter.   |
| <b>ZERO</b>   | Displays along with dashes when scale is zeroing.   |
| <b>LOCK</b>   | Flashes during weighing process. Stays displayed while weight measurement is locked.  |
| <b>OVERLOAD</b>   | Displays when weight on the scale exceeds capacity.   |
| <b>HEIGHT</b>   | Displayed when entering height during BMI process   |
| <b>LB</b>   | Indicates weight mode is in pounds.   |
| <b>KG</b>   | Indicates weight mode is in kilograms.  |
| <b>HOLD</b>   | Displayed when a weight is held or recalled after pressing the <b>HOLD/RLS/RECALL</b> button.   |
| <b>TARE</b>   | Displayed when a weight is tared.   |
| <b>BMI</b>  | Displayed when BMI value is calculated  |
| <b>CM</b>   | Displayed when entering height during BMI process in KG mode  |
| <b>IN</b>   | Displayed when entering height during BMI process in LB mode  |
|  | BT models only:<br>Icon is flashing: Indicates that the scale's wireless module is searching for an auxiliary wireless device to connect to.<br>Icon is solid: Indicates that the scale's wireless module is connected to an auxiliary wireless device. |



# OPERATING INSTRUCTIONS (CONTINUED)

## Weighing a Patient

**Note:** When this scale is turned on, it will always default to the settings and units last used (LB or KG).

1. With all weight off the scale, press the  button to turn on the scale.
2. Wait until the "0.0" LB or "0.0" KG appears on the display then assist the patient onto the scale. "LOCK" will appear and flash on the display along with a weight measurement. When a stable weight is determined "LOCK" will stay displayed along with the patient's weight. Depending on the movement of the patient on the scale, it may take several seconds for the scale to lock onto the weight.

**Caution: To prevent patient injury, the patient must be attended throughout the entire weighing event.**

3. The weight may be held on the display by pressing the **HOLD/RLS/RECALL** button. To release, press the **HOLD/RLS/RECALL** button again.
4. After the weight measurement has been taken and is recorded, have the patient step off the scale. Or press the **CLEAR/REWEIGH** button to reweigh the patient without having them step off the scale.
5. Press the  button to turn the scale off.

**Note:** The scale will not lock on a weight less than 5 lb / 2.27 kg.

## Weight Recall

1. To recall the last weight measured, press **HOLD/RLS/RECALL**.
2. To clear the display of the recalled weight, press **HOLD/RLS/RECALL** again.

## Zero Function

The **ZERO/TARE** button zeroes the scale prior to a weight measurement. The **ZERO/TARE** button is also used in the Tare function as outlined below.

## Tare Function

When using this scale, the weight of an object, such as a portable oxygen tank, can be subtracted from the total weight in order to determine the weight of the patient alone.

## Weighing a Patient and Taring an Unknown Weight:

The minimum weight that can be tared is 5 lb / 2.27 kg. **Note:** The scale must lock onto a weight before it can be tared.

1. With all weight off the scale, press the  button to turn on the scale.
2. Wait until the "0.0" LB or "0.0" KG appears on the display then place the object on the scale. The display will show a value for the object's weight.
3. Press the **ZERO/TARE** button. The word "TARE" will appear on the display, followed by "0.0" LB or "0.0" KG.
4. Keep the object on the platform, and then ask the patient to step onto the scale as well. The scale will automatically deduct the weight of the object and only display the patient's weight.
5. When you remove the patient and the item from the platform, a negative value will show on the display. Press the **ZERO/TARE** button to clear the tared value.

## OPERATING INSTRUCTIONS (CONTINUED)

### **Weighing a Patient and Taring a Known Weight (Pre-Tare):**

Pre-Tare can be performed for items between 0.2 lb and 200 lb (0.1 kg and 91 kg).

1. With all weight off the scale, press the  button to turn on the scale.
2. Wait until "0.0" LB or "0.0" KG appears on the display. Press and hold the **ZERO/TARE** button until the word "TARE" appears on the display.
3. The tare icon will flash along with "0.0" LB or "0.0" KG prompting you to enter the weight to be tared. Use the **▲** and **▼** keys to increase or decrease the weight. Pounds will change in 0.2 lb increments and KG will change in 0.1 kg increments. Holding down the arrow keys will cause the rate of the change to progress faster.
4. Once the desired tare value is set, lock the value by pressing the **ENTER** button. The tare icon will stop flashing and remain on, and the entered amount will show as a negative.
5. Weigh the patient following the weighing procedure outlined on the previous page. The scale will automatically deduct the tare value and only display the patient's weight.
6. To clear the tare value, press the **ZERO/TARE** button.

### **BMI Function**

Body Mass Index (BMI) is a ratio between a person's weight and height and interpreted as a BMI score. This BMI score is then used as a tool to categorize a patient as underweight, normal, overweight, obese or morbidly obese.

1. With all weight off the scale, press the  button to turn on the scale.
2. Wait until "0.0" LB or "0.0" KG appears on the display then assist the patient onto the scale. "LOCK" will appear and when a stable weight is determined, the patient's weight will also be displayed. Depending on the movement of the patient on the scale, it may take several seconds for the scale to lock onto the weight.  
**Caution: To prevent patient injury, the patient must be attended throughout the entire weighing event.**
3. After obtaining the patient's weight, press the **BMI** button.
4. The display will show "65.0" (in LB mode) or "150.0" (in KG mode). Use the keypad **▲** and **▼** buttons to enter the patient's height in inches if weighing in lb or centimeters if weighing in kg. Holding down the arrow keys will cause the rate of change to progress faster.
5. Once height is keyed in, press the **ENTER** button.
6. The display will show the patient's BMI.
7. Press the **CLEAR/REWEIGH** button to return to the normal weighing mode of the scale.

# ASSEMBLY INSTRUCTIONS FOR OPTIONAL HEIGHT ROD (499KLROD)

**Note:** These instructions are for mounting the optional height rod (499KLROD) to the 499KL/499KG scale. A height rod is not included with the 499KL/499KG scale and can be purchased separately as item # 499KLROD.

## Mounting 499KLROD

1. Remove the 2 plastic screw covers on the pillar of the scale.

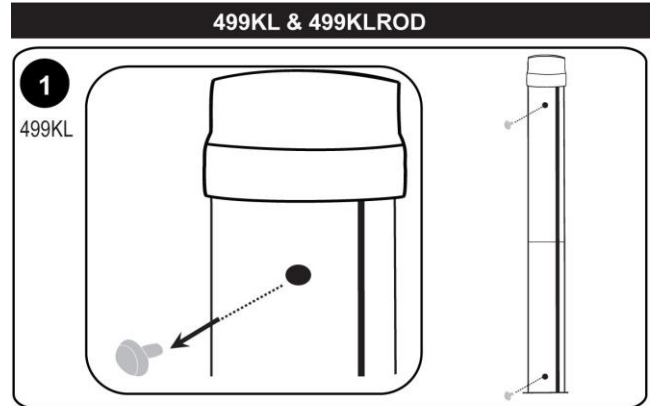

2. Insert the enclosed screws into the holes on the pillar.

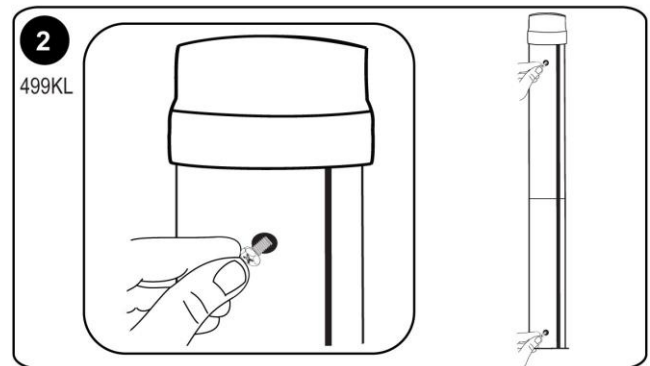

3. Position the large keyhole slots on the height rod over each screw head. When positioned correctly over both screws, gently slide the 499KLROD all the way down, in order to secure the keyhole locks.

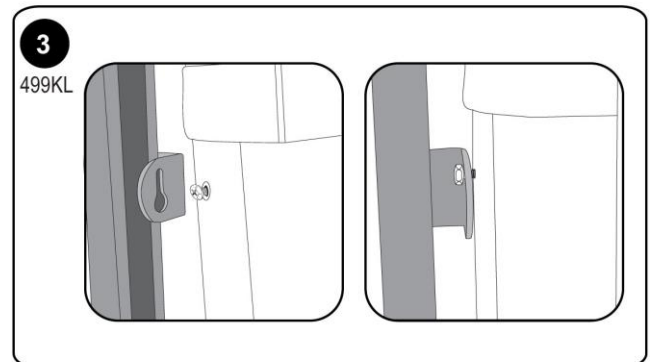

4. Tighten the screws with the enclosed wrench (wrench is provided with the 499KLROD). An open-ended wrench can be used to tighten screws as well.

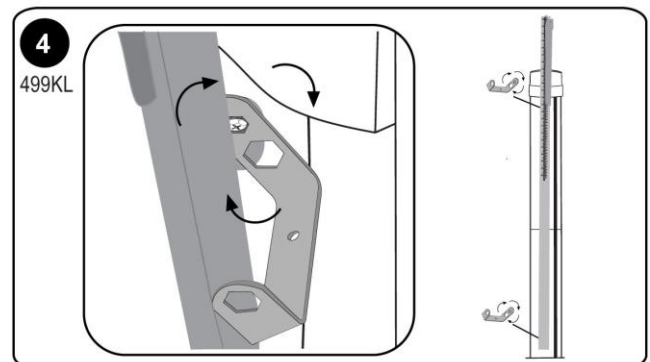

# HEIGHT MEASUREMENT INSTRUCTIONS

**Note:** These instructions are for measuring height using the optional height rod. A height rod is not included with the scale and can be purchased separately as item # 499KLROD.

**WARNING:** Use caution when sliding height rod up and down. The rod should move smoothly. Fold headpiece down when not in use.

**Note:** A patient needs to be a minimum of 23-5/8" (60 cm) in height.

1. With the headpiece in the folded down position, slide the headpiece up or down to the estimated height of the patient. Then raise the headpiece into its horizontal position.

**NOTE: FOLD HEADPIECE DOWN BEFORE EXTENDING HEIGHTROD**



Push tab inward to lower height rod below 46 3/8"

To lower height rod below 46 3/8", push the tab at the top of the height rod and gently lower the headpiece.

2. Ensure that the patient's posture is upright, and that the patient's head is straight and level. Slide the headpiece down until it rests on the patient's head.



3. Determine the patient's height by reading the value on the measuring strip nearest to the line on the indicator, as shown on the next page.

# HEIGHT MEASUREMENT INSTRUCTIONS

Height Rod Below 46 3/8"

Height Rod Extended Above 46 3/8"

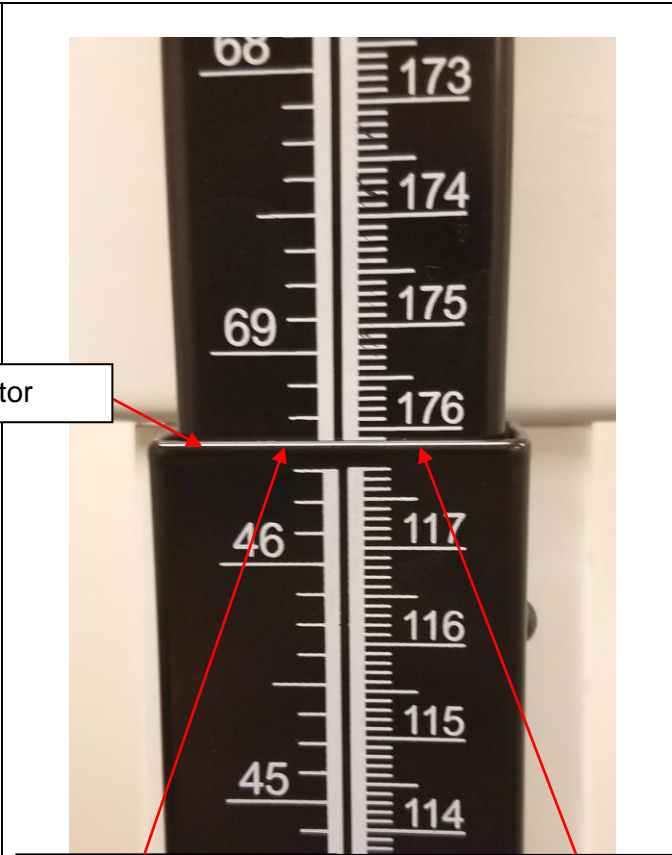
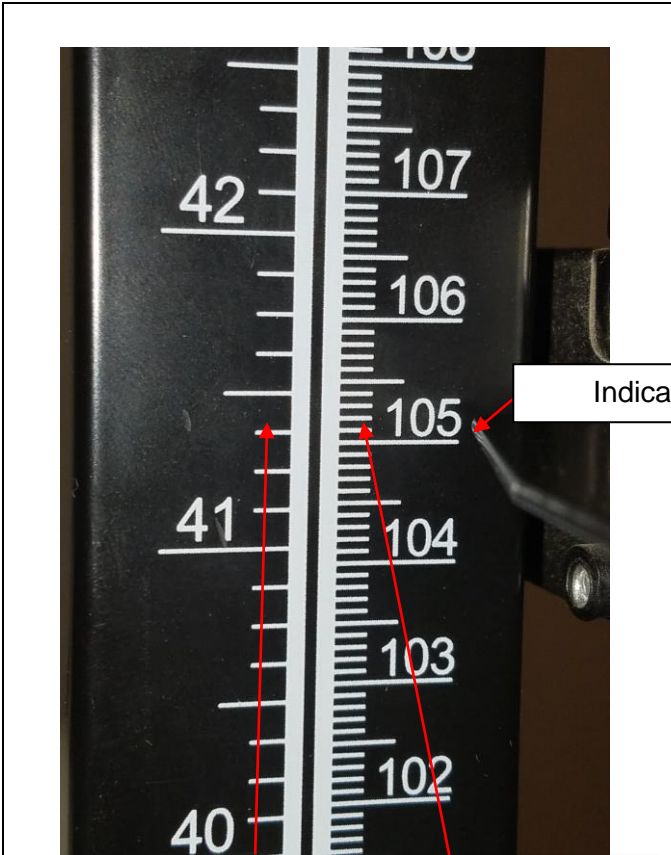

Inches read: 41" + 3/8" = 41 3/8"

Cm read: 105 cm + 0.2 cm = 105.2 cm

Inches read: 69" + 3/8" = 69 3/8"

Cm read: 176 cm + 0.2 cm = 176.2 cm

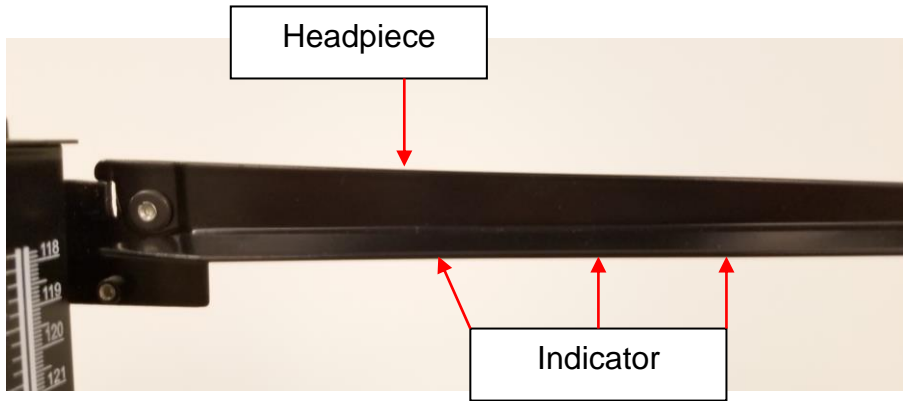

# MAINTENANCE

## **Maintenance**

The following pages provide instructions for maintenance, cleaning, calibrating, and troubleshooting of the scale. Maintenance operations other than those described in this manual should be performed by qualified service personnel.

**Caution: Before first use, or after long periods of non-use, check the scale for proper operation and function. If the scale does not operate correctly, refer to qualified service personnel.**

1. Check overall appearance of the total scale for any obvious damage, wear, and tear.
2. Inspect the AC adapter cord for cracking or fraying, or for broken/bent prongs.

**Note:** This scale is an extremely sensitive weighing device. Items such as clothing or towels placed or dropped on the scale may cause a scale to activate. In order to prevent battery depletion, do not store or leave anything on the scale.

## **Cleaning and Disinfecting**

Proper care and cleaning is essential to ensure a long life of accurate and effective weighing.

1. Health o meter® Professional recommends using one of the following solutions on a soft cloth or disposable wipe:

- mild soap and water solution
- 70% isopropyl alcohol
- solution with 1-5% hydrogen peroxide concentration

After cleaning/disinfecting, wipe with a cloth dampened with water and then with a clean dry cloth. To avoid residue build-up or damp surfaces, ensure all scale parts are completely dry after cleaning.

2. Never use rough or abrasive materials to clean the scale, as these will damage the scale's finish.
3. Do not submerge the scale in water or any other liquid.
4. Do not pour or spray fluids directly on the scale.

## **Replacement Parts**

Parts may be available if a piece of the scale needs to be replaced. Contact Health o meter Professional Scales Customer Service at 1-800-815-6615 to inquire about the availability of these replacement parts.

| <b>Part #</b>   | <b>Description</b>           |
|-----------------|------------------------------|
| 499KLROD        | Optional Height rod          |
| 499KLWHEELS     | Set of 2 wheels              |
| 499KLFOOT       | Foot for base                |
| 499KLMAT        | Replacement mat for platform |
| BATTDOR500      | Battery compartment door     |
| 499KLPILLARFOOT | Foot for pillar              |
| ADPT30          | Power adapter                |

# CALIBRATION

**This scale has been factory calibrated, and does not require calibration prior to use.**

There are no requirements for calibration in the field; users should adhere to their institution's calibration policies. If required, the scale can be calibrated. Calibration of your scale is performed using 80 kilograms (KG) or 200 pounds (LB), according to the units of measure used upon entering into the calibration path. **THE 499KG CAN ONLY BE CALIBRATED IN KILOGRAMS.**

If Everlock® is engaged the scale can only be calibrated in the locked unit of measure.

**Note: Only weights certified and traceable to national standards should be used for calibration procedures.**

1. Press and hold the **UNIT** and **ZERO/TARE** buttons at the same time, and press and release the  button to turn on the scale. Remain pressing the **UNIT** and **ZERO/TARE** buttons until "CAL" appears on the display. Release all buttons. **Note:** The display will show "CAL" until the button combination is released.
2. Once the buttons are released the following message will scroll horizontally across the screen : "– 2Ero SCALE –". With no weight on the platform, press the **ZERO/TARE** button.
3. The scale will zero and the following message will scroll horizontally across the screen: "- PLACE 200 ON SCALE PrESS EnTEr–" (if in pounds) or "– PLACE 80 ON SCALE PrESS EnTEr–" (if in KG). You may toggle between pounds and kilograms using the **UNIT** button. If Everlock® is engaged you will only be able to calibrate in the locked weight measurement unit.
4. Once the proper weight is placed on the platform, press the **ENTER** button. The message "– CAL –" will flash on the screen while the scale is calibrating.
  - A. If the weight is within calibration range, a four digit number will display for approximately 5 seconds then display the calibration weight. Calibration is now complete. Press the **CLEAR/REWEIGH** button to exit calibration mode.
  - B. If the weight placed on the scale does not match the correct calibration standard (200 lb or 80 kg), the following message will be displayed: "– Out OF RANGE –". Calibration is not performed. Press the **CLEAR/REWEIGH** button to exit calibration mode. Obtain the correct amount of calibration weight and begin the calibration process again.

# TROUBLESHOOTING

## Troubleshooting

Before contacting service personnel, refer to the following instructions to check and to correct any failures. If display shows other error messages than displayed below, contact Health o meter® Professional Scales Technical Support at 1-800-638-3722.

| Symptom   | Possible Cause  | Corrective Action  |
|---|---|--|
| Scale does not turn on  | 1. Dead battery<br>2. Faulty electrical outlet<br>3. Bad power supply   | 1. Replace batteries<br>2. Use a different outlet<br>3. Replace AC adapter   |
| Questionable weight or the scale does not zero  | 1. External object interfering with the scale<br>2. The display did not show "0.0" before weighing<br><br>3. Scale is not placed on a level floor<br><br>4. Scale is out of calibration | 1. Remove interfering object from the scale<br>2. Ask the patient to get off the scale, zero the scale and begin weighing process again<br>3. Place the scale on a level floor and begin weighing process again<br>4. Check weight with known weight value |
| Weighing is performed but the weighing process takes too long and the weight does not lock on the display | The patient is not standing still   | Ask the patient to stand still   |
| The display shows "UNDeR"   | A negative weight is present  | Press the <b>ZERO/TARE</b> button to zero the scale.   |
| The display shows dashes and the "OVERLOAD" icon is displayed   | The weight on the scale exceeds the capacity  | Remove the excess weight and use the scale according to its limits   |
| The display shows "LoBat" and scale powers off  | The batteries are depleted  | Replace batteries according to instructions  |
| The display shows "Error LOAD CELL"   | Load cell connector cable is not plugged in or load cell is damaged   | Refer to the instructions below to inspect the load cell cable.  |

## Inspecting the Load Cell Cable



1. Using a Phillips screwdriver, remove the door at the back of the platform base.

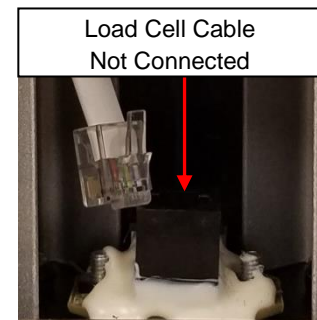
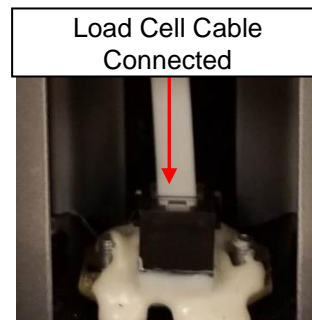

2. Inspect the load cell connector cable to ensure it is completely plugged into the RJ jack. If cable was plugged in, unplug and plug in again until it clicks into place. After checking connection, replace door at the back of the platform base.



# WARRANTY

## **Limited Warranty**

### **What does the Warranty Cover?**

Health o meter® Professional scales are warranted from date of purchase against defects of materials or in workmanship for a period of two (2) years. If product fails to function properly, return the product, freight prepaid and properly packed to Pelstar, LLC (see "To Get Warranty Service", below, for instructions). If the manufacturer determines that a defect of material or in workmanship exists, the customer's sole remedy will be replacement of the scale at no charge. Replacement will be made with a new or remanufactured product or component. If the product is no longer available, replacement may be made with a similar product of equal or greater value. All replaced parts are covered only for the original warranty period.

### **Who is Covered?**

The original purchaser of the product must have proof of purchase to receive warranty service. Please save your invoice or receipt. Pelstar dealers or retail stores selling Pelstar products do not have the right to alter, or modify or any way change the terms and conditions of this warranty.

### **What is Excluded?**

**Your warranty does not cover normal wear of parts or damage resulting from any of the following:** negligent use or misuse of the product, use on improper voltage or current, use contrary to the operating instructions, abuse including tampering, damage in transit, or unauthorized repair or alternations. Further, the warranty does not cover natural disasters, such as fire, flood, hurricanes and tornadoes. This warranty gives you specific legal rights, and you may also have other rights that vary from country to country, state to state, province to province or jurisdiction to jurisdiction.

**To get Warranty Service make sure you keep your sales receipt or document showing proof of purchase.** Call (+1) 800-638-3722 or (+1) 708-377-0600 to receive a return authorization (RA) number, which must be included on the return label. Attach your proof of purchase to your defective product along with your name, address, daytime telephone number and description of the problem. Carefully package the product and send with shipping and insurance prepaid to:

Pelstar, LLC

Attention R/A# \_\_\_\_\_

Return Department

9500 W. 55<sup>th</sup> St.

McCook, IL 60525

### **Extended Warranty Available\***

This scale is eligible for Health o meter® Professional ScaleSurance® Extended Warranty Program. ScaleSurance® extends the warranty period for an additional two years. This extension to the standard Limited Warranty can be purchased with new scales or for a facility's existing scale before its current warranty has expired. To learn more, visit [www.homscales.com/scalesurance/](http://www.homscales.com/scalesurance/) or contact your medical supply distributor.

\*Not available in all countries



**PELSTAR®, LLC**

**9500 West 55th St. McCook, IL 60525-7110 USA**

**1-800-638-3722 or 1-708-377-0600**

PLEASE REGISTER YOUR SCALE FOR WARRANTY COVERAGE AT:

[www.homscales.com](http://www.homscales.com)

Health o meter® is a registered trademark of Sunbeam Products, Inc. used under license. Health o meter® Professional products are manufactured, designed, and owned by Pelstar, LLC. We reserve the right to improve, enhance, or modify Health o meter® Professional product features or specifications without notice.

© Pelstar, LLC 2020