

HemoCue® Albumin 201 System



The Easy Way to Reliable Early Detection

Fast, portable, and easy to use, the HemoCue® Albumin 201 system is ideal for working with diabetes or hypertension treatment, or for detecting preeclampsia during pregnancy checkups.

The HemoCue® Albumin 201 System is an easy, lab-accurate means of identifying albuminuria – long before symptoms of renal or vascular complications appear. HemoCue's patented microcuvette technology enables quantitative test results right at the Point-of-Care. So you can make immediate treatment decisions, rather than waiting for a lab to confirm semi-quantitative tests.

- ▶ The only CLIA-waived device for diagnosing and monitoring Albuminuria at the Point-of-Care
- ▶ The only CLIA-waived device offering immediate results that could be used for adjusting patient medications during an office visit
- ▶ The only objective quantitative analysis that allows for billable positive and negative results

Accuracy Starts With Us



HemoCue® Albumin 201 System

Principle	Turbidimetric immunoassay determination of urine albumin
Calibration	Factory calibrated against a turbidimetric method with a calibrator traceable to CRM 470 (Certified Reference Material)
Sample Material	Urine morning spot or 24 hour collections
Measurement Range	7–150 mg/L
Results	In about 90 seconds
Sample Volume	18 µL
Dimensions	4.53×6.89×2.56 inches
Weight	350 g (0.77 pounds)
Storage Temp.	The analyzer can be stored at temperature 0–50 °C (32–122 °F).
Operating Temp.	15–30 °C (59–86 °F)
Power	AC adapter
Interface	Printer and PC
Quality Control	Built-in self-test and liquid controls

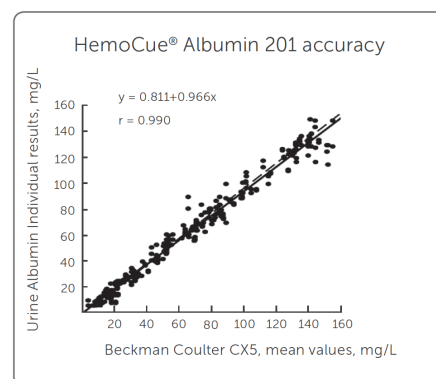

Regression plot of urine sample, for the HemoCue Albumin 201 system versus Beckman Coulter CX5. n=143

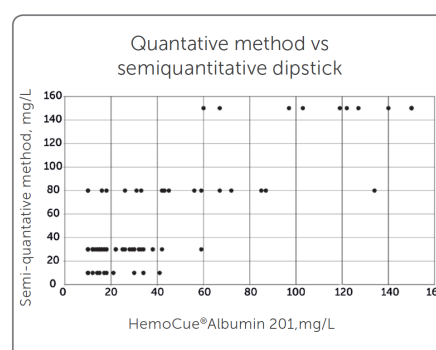

The significant overlap that occurs when a semi-quantitative dipstick is used instead of a quantitative method.

A Few Simple Steps

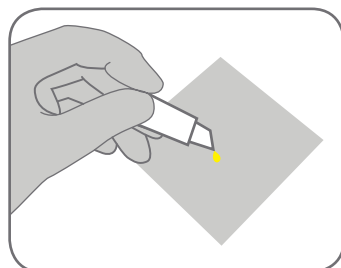

1 Fill microcuvette.

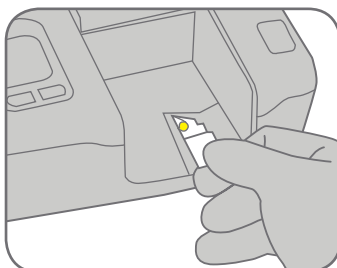

2 Place microcuvette into analyzer.

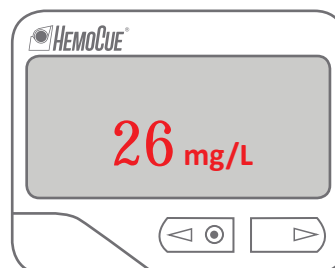

3 View results.

Hemoglobin | Glucose | Urine Albumin | WBC

HemoCue America | California, USA
Phone 800.881.1611 | Fax 800.333.7043 | info@hemocue.com | hemocue.com

HemoCue has been a leader in Point-of-Care medical diagnostics for over 30 years. We specialize in giving healthcare providers lab-quality accuracy with results comparable to that of a clinical lab.

