



High Density Storage & Filing



A PLACE FOR EVERYTHING.

And we do mean everything! Mayline goes beyond simple file storage with products that will accommodate various media such as banker's boxes, pharmaceuticals, sporting goods, tools and just about anything else you can imagine. We offer a wide range of space-saving, time-saving, money-saving solutions to meet your specific needs, plus free design services that will help you get the most out of your investment.

Many Mayline storage products are certified for indoor air quality. Look for this symbol in these pages – and learn exactly what this means at mayline.com or intertek.com.



TABLE OF CONTENTS:



Mobile 1000™
Pages 4-17



Mobile Lite
Pages 18-19



Kwik-Track
Pages 20-21



Four-Post Shelving
Page 22



Heavy-Duty Shelving
Page 23



ARC™ Rotary Files
Pages 24-25



File Harbor Cabinets
Pages 26-27



Lateral Files/Flip-N-File™
Pages 28-29



Plan Files
Pages 30-31



Laptop Carts
Page 31

MORE ROOM, LESS SPACE.



ROLL WITH IT.



Mobile 1000™

Mobile 1000 puts storage components on a sliding track – and saves up to 50% of your valuable real estate in the process. Simply roll storage banks along the track to access a specific location.

You can equip Mobile 1000 with cabinets, shelves, file drawers and more – you can even use competitive storage components. You can also mobilize your existing lateral files. Best of all, Mobile 1000 is modular and reconfigurable, so it's easy to expand and relocate.



- Easy to move – 1 lb. of effort rolls 10,000 lbs. back and forth along tracks.
- Increases filing capacity by up to 75% compared to the same footprint of conventional filing.
- Can be installed around obstructions, atop raised floors and on floors above ground level.
- Tracks can be located in 6" increments for greater flexibility in distributing weight loads.
- Rear-track flush-mount option positions system close to walls.
- Magnetic decorative panels bring fabric and laminate elements to your filing system.
- ADA/Cart Incline Ramp.



Wire shelving option reduces dust and contamination build-up. Wire shelves are NSF-listed for dry storage environments.



Open shelving option is ideal for items like medical/pharmaceutical supplies. Shelves are available in 18-gauge or 22-gauge steel.

BUILT TO MOVE. BUILT TO LAST.



Floor-friendly design: non-grouted track, wheel channel assembly, unfinished decking, full-length drive shaft, modular bases and four-post uprights and supports.

You're On The Right Track.

The Mobile 1000 track is something of an engineering marvel – rugged enough to support thousands of pounds but nimble enough to expand or relocate with ease. While most heavy-duty mobile systems are grouted and permanently attached to the floor, Mobile 1000 features a non-grouted, interlocking steel track. So it won't leave you spinning your wheels as you grow!

- Modular carriages support up to 8,000 lbs. each.
- All-steel construction, including full-height end panel.
- Standard in-track anti-tip mechanism.
- Continuous drive shaft runs entire length of range to prevent racking.
- Mobile 1000 Mechanical Assist moves up to 30 ft. in range length.
- Manual Mobile Aisle is designed for ranges up to 8 ft.





All-steel, dual-flanged wheels are 4 5/8" in diameter.



Rugged steel tracks offer leveling glides every 6" – easy to re-level.



Standard ramp entry option: low-profile 1.5" step-up from the floor.



ADA/cart ramp option: incline occurring within system.



Tracks interlock and overlap for superior strength and stability.



Optional floor lock enhances security.



1" bumper protects both shelving and user.



Optional posting/reference shelf pulls out for easy access.



Red indicator on handle alerts users when aisle is in use.

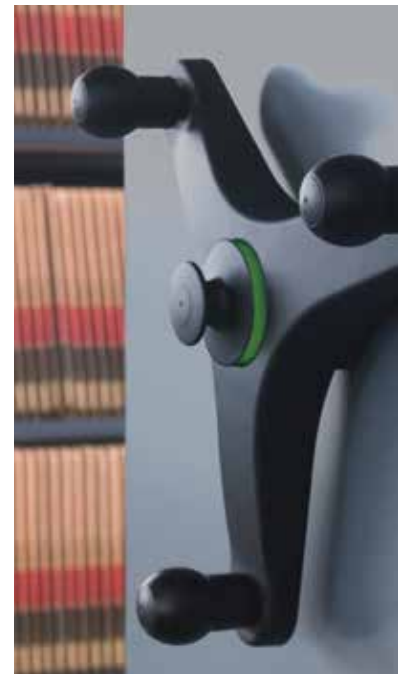

Green means go – aisle is not in use and it's safe to start rolling.

DO MORE WITH A DRAWER.



Roll-out drawers, available in three heights and four widths, provide limitless storage applications.



Roll-Out Drawers

Mobile 1000 brings you more than lateral file drawers – we also offer a variety of smaller partitioned drawers to accommodate everything from computer media to office supplies. You can mix drawer sizes to suit your unique storage needs.

- 4½", 6" and 10½" height options; 24", 30", 36", 42" and 48" widths.
- Store letter and legal hanging files, front-to-back or left-to-right.
- Flush-front design with full-width recessed pulls.
- Heavy-duty, soft-closure retention slides.



6" and 10½" drawers offer a key-lock option.

MAKE A LATERAL MOVE.

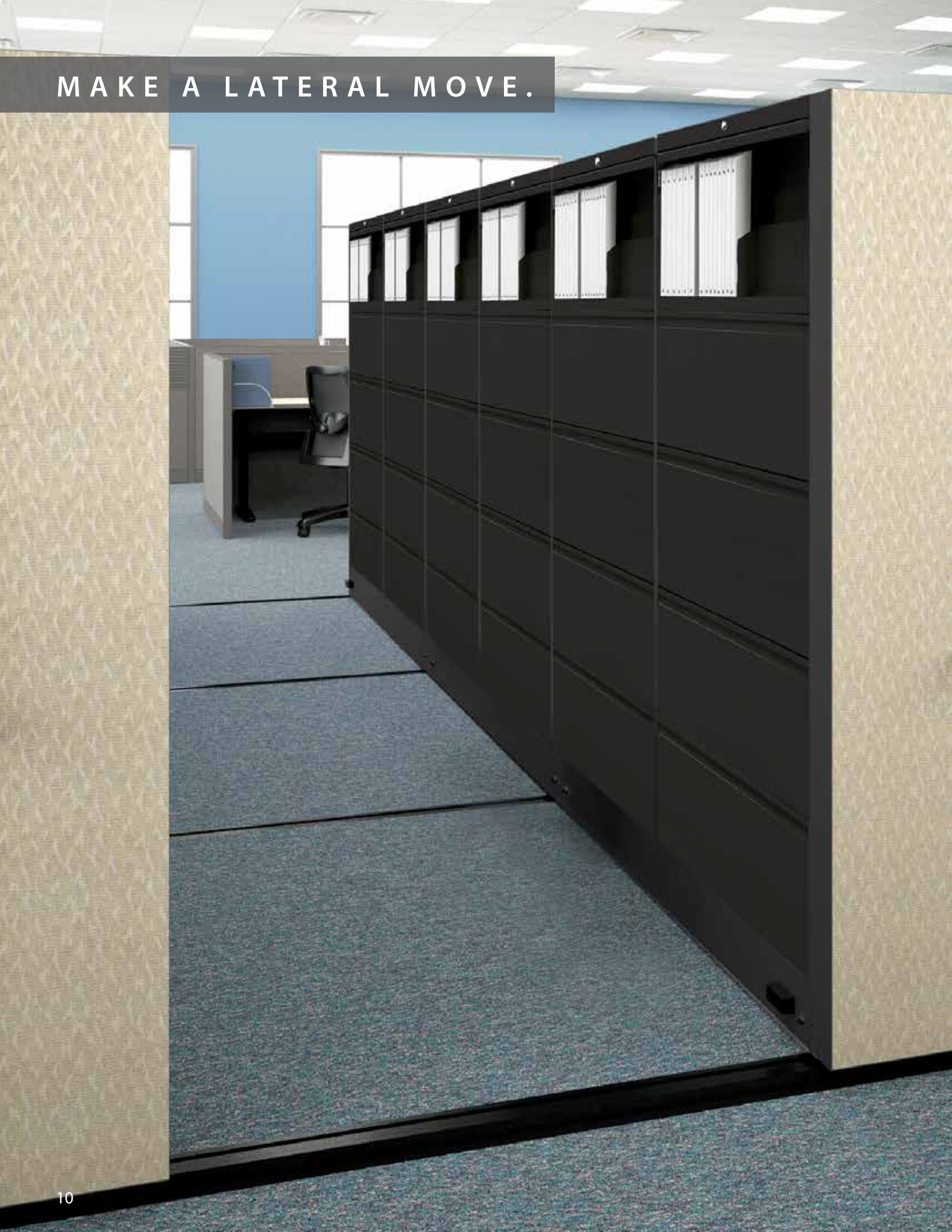



Cut Your Storage Space in Half!

You can save 50% of your valuable real estate space* by mobilizing your existing lateral files with Mobile 1000.

That's space you can use to expand offices, accommodate more people or simply open up cramped spaces.

Saving real estate saves money – in most cases a Mobile 1000 system will pay for itself in 15 months or less.

** That's an impressive return on investment.

Mobilizing your lateral files is a lot easier than you might think. Our Space Planning professionals can show you exactly how to do it. Contact us for a FREE quote/plan: Spaceplanning@Mayline.com

**Based on a cost/sq. ft. of \$30 or higher.

Stationary Lateral Files*

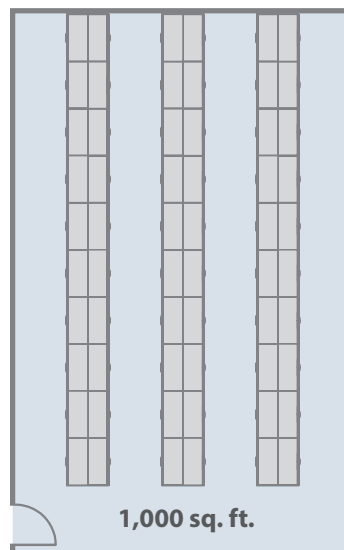

Mobilized Lateral Files

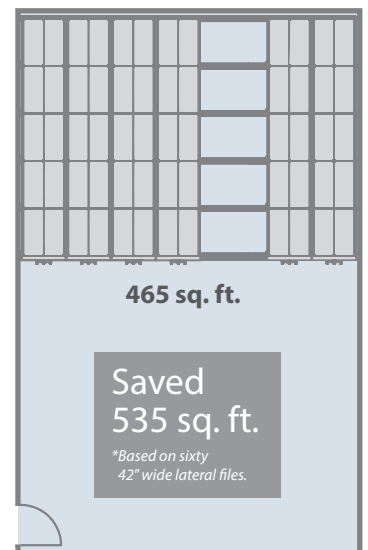

THINK OUTSIDE THE BOX.



Open Mobile 1000 frames equipped with display hooks and baskets are ideal for space-saving storage in retail backrooms.



CSI-Mayline: Mobile 1000 is great for weapon and evidence storage.



Best in Class: Neat, organized storage of school textbooks and supplies.

Slatwall Storage & Accessories

Slatwall makes Mobile 1000 even more flexible – with bins, wire baskets, trays, shelves, display hooks and other specialized accessories that can organize and store non-traditional items. It’s a great solution for healthcare, education, retail, law enforcement and a whole host of other market segments.

- Aluminum and steel, painted components (standard).
- 3 heights and 3 widths.
- Attach without hardware or fasteners.
- Can be used in both mobile and stationary shelving.
- Slatwall available in Black only.



Intertek



Prescription for Success: A more efficient way of storing medical equipment.

SPICE UP YOUR STORAGE.



Magnetic veneer panels add stately elegance to Mobile 1000 in the law library.



Guilford of Maine fabric options.



Woodgrain or patterned options.



15 corporate paint colors.



Magnet-backed enhancement.

Decorative Enhancements

You can customize your Mobile 1000 system quickly and cost effectively with our magnet-backed fabric. Or choose one of our many standard paints – you can always enhance it with a magnetic panel later. Magnet-backed tackboards are also available.

- Installs in just minutes.
- Fabrics and finishes match Mayline's standard offering.
- For use on most of our high-density storage and filing products.
- Due to the magnetic backing, not recommended for film, diagnostic or electronic media storage.



VERSATILITY MEETS VALUE.



Bank on Mobile 1000 – it's the most compact, efficient, affordable way to store banker's boxes.



Shoe Store: Another example of backroom retail storage.



Flexible Storage: With Mobile 1000.



Whole New Ballgame: Easy, accessible storage of sporting goods.



Dressed To Thrill: Magnet-backed end panel enhancements.

Don't Get Locked In Place.

Fixed storage is the most obvious solution – but it's not always the best. Mobile 1000 offers better space efficiency, easier item location and retrieval, more storage flexibility, and the ability to grow and change with your business.

The possibilities are virtually endless!



Behind Closed Doors: Mobile 1000 with Mayline File Harbors (pgs. 26-27).

MAKE A MOVE FOR LESS.



Mobile Lite costs less per filing inch than most alternative filing options. Open shelves are ideal for end-tab filing systems.



Like its more robust cousin, Mobile Lite increases storage capacity by eliminating fixed aisles. It's perfect for items like medical supplies.

Mobile Lite

Think of Mobile Lite as the streamlined version of Mobile 1000 – same concept with a few tweaks that make it even more affordable. It not only costs less, it installs in half the time of larger, heavy-duty systems.

- Increases storage capacity by eliminating fixed aisles.
- Shelf storage for end-tabbed files, boxes and supplies.
- Optional pull-out reference shelf.
- Holds 240 lbs. per shelf.
- Optional security handle with key lock.
- Optional lockable security shades.



Intertek



Waist-high handle with range lock fixes aisle in place while user retrieves items.



ADA-compliant, heavy-duty aluminum track offers anti-tip feature for safety. No grouting required.



Aluminum carriages support up to 1,000 lbs. per linear foot.

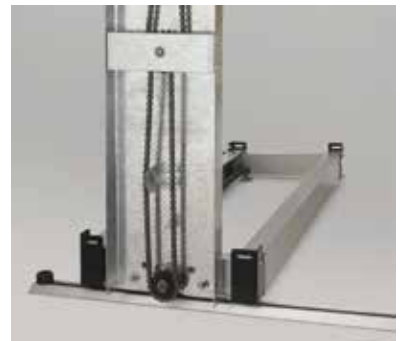

Full-length driveshaft in end panel ensures simultaneous movement.

WHEN YOU'RE UP AGAINST THE WALL.



Flip Slide: Kwik-Track with Mayline Flip 'N File Cabinets (p. 29).



Go Deep: Kwik-Track with Four-Post Shelving (p. 22) in a 3/2/2 configuration.

Kwik-Track

When space is really at a premium, you need Kwik-Track. It allows you to put one or two rows of laterally moving storage units in front of stationary storage units placed against the wall. You can mobilize open file shelving or cabinets to provide greater storage and filing efficiency.

- Multiple letter and legal configurations are available.
- Low-profile track is ADA-compliant.
- In-track anti-tip safety feature.
- Aluminum track with steel inserts.
- Future expansion requires minimal dismantling of current system.

Configurations



2/1
2 rows; 2 fixed, 1 movable



3/2
2 rows; 3 fixed, 2 movable



4/3
2 rows; 4 fixed, 3 movable



2/1/1
3 rows; 2 fixed, 2 movable



3/2/2
3 rows; 3 fixed, 4 movable



4/3/3
3 rows; 4 fixed, 6 movable



Sliding Doors: File Harbor Cabinets with locking tambour doors (pgs. 26-27) on Kwik-Track .

SUIT YOUR SHELF.

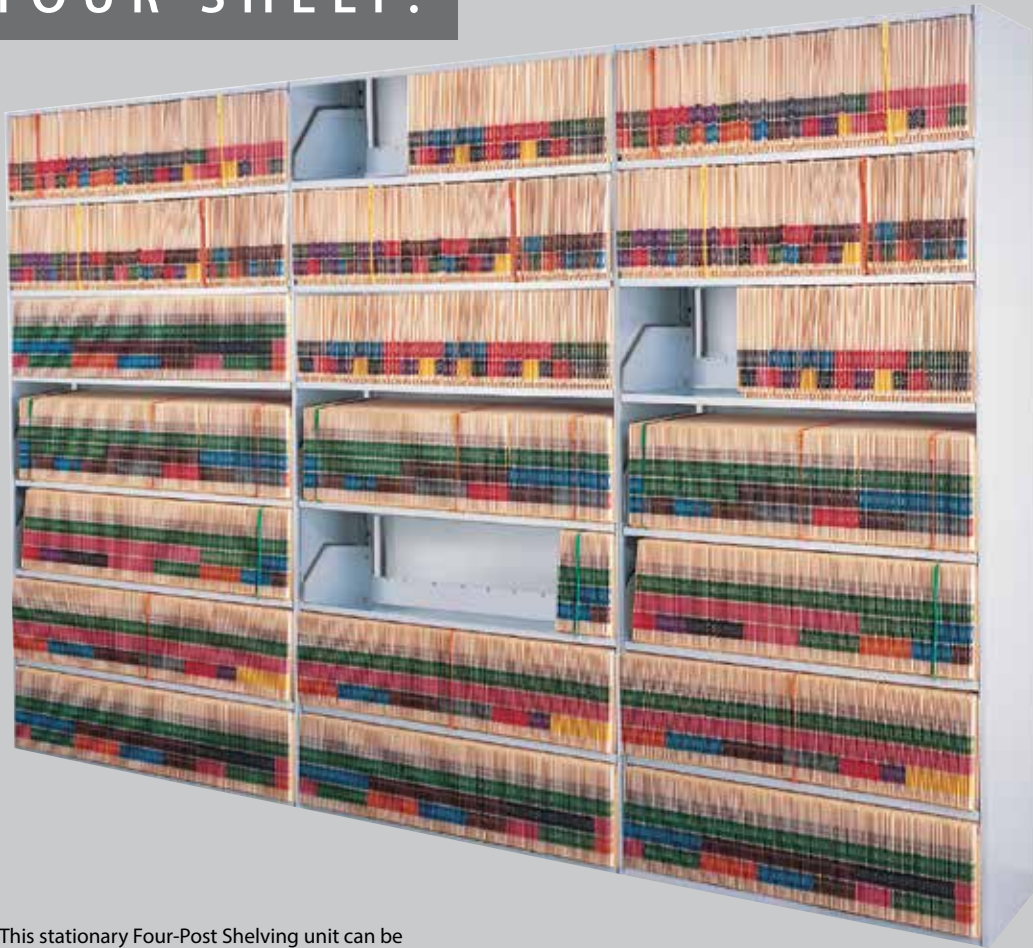

Expand Your Options: This stationary Four-Post Shelving unit can be easily mobilized on Mobile 1000, Mobile Lite or Kwik-Track.

Four-Post Shelving

The most efficient, economical solution for your storage and filing needs, Four-Post Shelving allows greater visibility and one-touch retrieval of end-tab filing. It also accommodates box and archival storage as well as a variety of custom storage options. Stationary Four-Post Shelving can be easily mobilized.

- Five shelf heights, five widths and six depths.
- Supports letter and legal filing.
- Shelves adjust on 1½" centers, dividers on 3" centers.
- Easy to assemble, no hardware required.
- Holds 240 lbs per shelf.
- Optional reference shelf and back panel.



Optional zinc-plated wire shelving.



Optional wall placement.



Optional roll-out drawers in three heights.

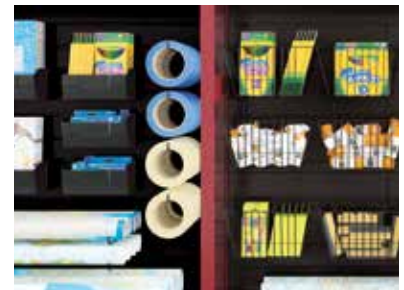

Optional slatwall and accessories.

Heavy-Duty Shelving

This heavy-duty shelving offers exceptional weight-load capacity and greater shelf depths to support heavier, larger items. Easily accommodates taller-than-standard vertical openings as well.

- Supports up to 1,000 lbs. per shelf.
- Shelves made of 18-gauge steel.
- Available in single-face (18") and double-face (36") depths.
- Oversized dividers adjust on 3" centers.
- Five standard widths.
- Easy to assemble, no hardware required.



Security Shade

This vertical locking tambour door is an affordable alternative to purchasing new locking filing systems.

- Easily installs on existing Four-Post Shelving with basic width/height dimensions.
- No need to remove files for door installation.
- Doors and tracks offered in three widths and three heights with graphite color finish.
- Steel housing for doors is available in 15 standard colors; custom colors available on request.
- For use with Stationary Four-Post Shelving, Heavy-Duty Shelving, Mobile Lite, Kwik-Track and Mobile 1000.
- Cannot be used with a reference shelf.
- Doors available in Graphite only.



STORAGE COMES FULL CIRCLE.



Both Sides Now: ARC Rotary Files rotate to allow two-sided access, reducing storage space requirements and easing item retrieval.



The Arc Rotary Work Center provides convenient storage for end-tab and top-tab filing, binders, supplies and other materials. Optional worksurface creates a standing-height table.

ARC Rotary Files

ARC Rotary Files fit where other files won't. Minimal access space is required because no doors or drawers protrude into aisles. Yet you can access twice the amount of material from a single vantage point, compared to conventional filing solutions. There are no cumbersome foot pedals to operate, a slight push is all it takes to rotate cabinets. Each unit has a standard lock to maximize security and peace of mind.

- Choose from six preconfigured units or specify your own storage variations.
- Universal base lets you expand system in either direction.
- Units are lockable and secure (standard)
- Options include reference shelf, cantilevered slotted shelf, roll-out drawers, roll-out shelves, roll-out hanging file frames and pass-through shelves.
- "ARC-in-the-Box" units shipped assembled – leveling and shelf/divider installation required.
- Holds 120 lbs. per shelf.



Files are equipped with a rotating mechanism that self-locates every 90°, plus a standard security lock.



Optional pull-out reference shelf eases file notations.



Cantilevered shelf is adjustable on both sides of unit.

Roll-out drawers are available in five heights.

SAFE HARBOR FOR CONFIDENTIAL FILES.

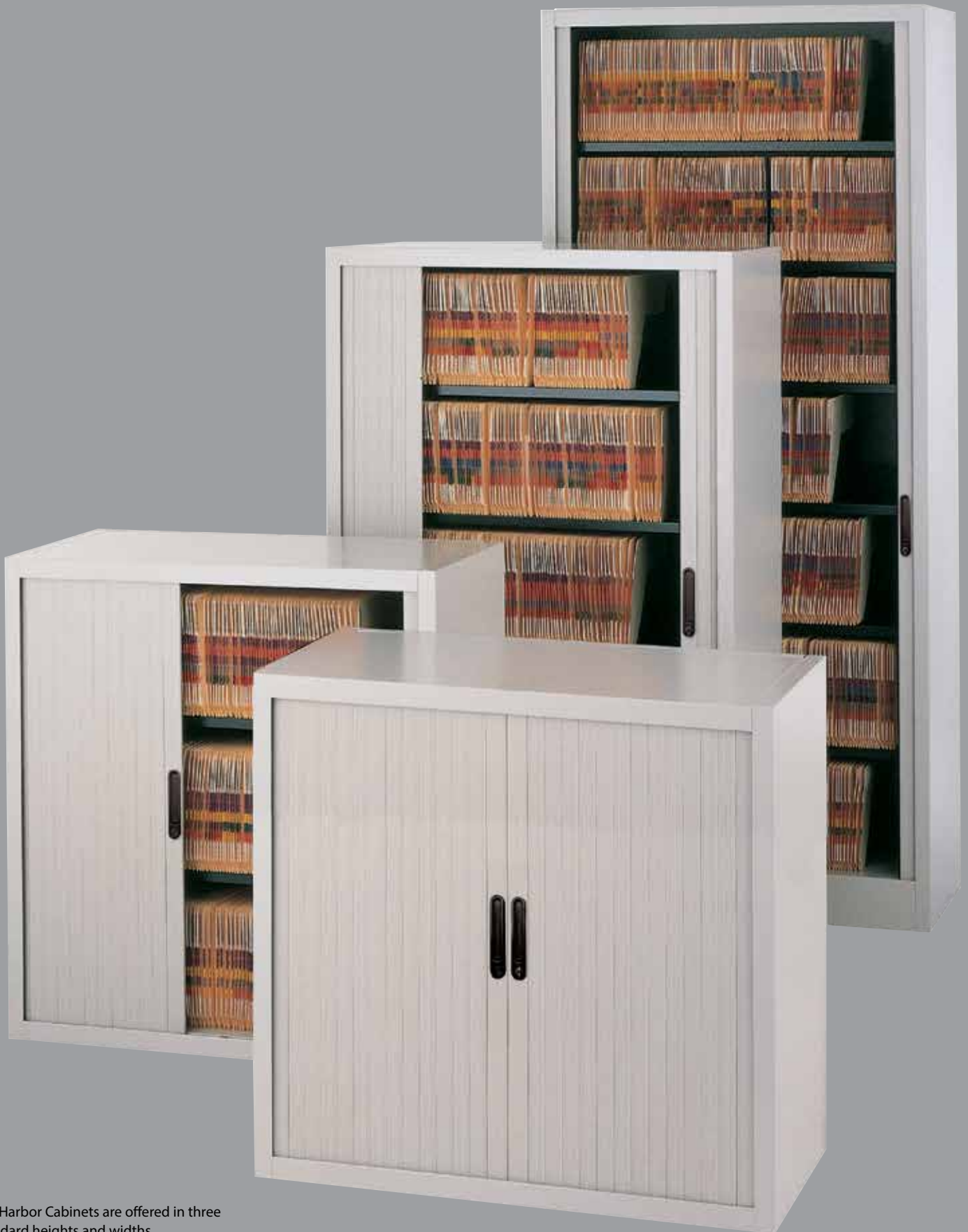

File Harbor Cabinets are offered in three standard heights and widths.

File Harbor Cabinets

The most unique and universal cabinet on the market, File Harbor is distinguished by a locking tambour door that secures interior contents while providing a totally distinctive look. The horizontal doors recede into the cabinet to keep aisle clear and free up space – you gain approximately 6 sq. ft. each time a File Harbor Cabinet replaces an existing 42"-wide lateral file.

- Multiple storage configuration options accommodate a variety of media.
- Lower cost per filing inch than vertical or lateral drawer files.
- Available in three standard heights and widths.
- Can be installed on Mobile 1000 and Kwik-Track.
- Ideal for personal workstation storage – helps define space and provide privacy.
- Holds 200 lbs. per shelf.
- Reference shelf holds 100 lbs.



File Harbor Cabinets are available with preconfigured components for end-tab filing, but you can also specify your own unique storage variations – like this one.



Optional reference shelf for note-making.



Optional roll-out drawers and file frames.

TOUGH CHOICES.



Lateral Files

Rugged, all-steel construction delivers lateral files that are built to last – Mayline ingenuity delivers them at an exceptional value.

Stylish recessed pulls combine with heavy-duty, full-extension telescoping slides to ensure easy operation time after time.

Files can be mobilized on Mobile 1000 or Kwik-Track to make them even more space-efficient.

- 36"- and 42"-wide units available in 2, 3, 4 or 5 high.
- Top drawer of 5-high unit is a roll-out shelf.
- Side-to-side rails support letter, legal or A4 filing.
- All units feature an anti-tip interlocking drawer system.
- Front to back filing rails and dividers available.
- Standard finish options: Black, Medium Tone, Desert Sage and Mist.

Flip 'n File

Rugged, affordable Flip 'n File units are offered in a choice of open- or closed-door designs featuring fixed shelves with standard painted steel dividers. Retractable spring-assisted doors with recessed pulls respond easily to the touch for quick, complete accessibility to files without blocking aisles.

- 36"-wide open- or closed-door units in 5, 6 and 7 tier configurations.
- Allows both letter and legal filing.
- Four dividers provided per shelf, adjustable in 1" increments; additional dividers available.
- Label holders on closed-door units help identify contents.
- Adjustable levelers and glides assure smooth operation.
- Standard security lock on each closed-door unit.
- Can be mobilized on Kwik-Track.
- Holds 120 lbs. per shelf.



Forms & Storage

Interchangeable all-steel components in F/S Cabinets allow you to reconfigure your interior space to organize virtually any type and size of media. Sorting shelves have a thumb-cut design and beveled flanges on the front edge for easy retrieval and labeling. Optional roll-out work shelf allows you to sort and retrieve stored information quickly and efficiently.

- Organize, sort, collate, and store forms, literature, binders and more.
- Available in two heights and two widths.
- 42 standard configured models or create your own.
- Interlocking shelves adjust on 1/2" increments.
- All-welded steel construction with 18-gauge steel shelves and supports.
- Optional locking door.
- Holds 50 lbs. per shelf.



OUT-OF-THE-ORDINARY STORAGE.



Steel Plan Files

All Steel Plan Files feature rugged steel construction, choice of flush or raised bases, stackable convenience and the capacity to store three standard sheet files.



C Files®

- Self-contained with an integral cap.
- Three sizes available in 5- and 10-drawer configurations.

Hamilton Unit System®

- Interlocking files with a patented tracing lifter.
- Four sizes available in 5- and 10-drawer configurations, for up to 42" x 72" sheets.

Interlocking Files

- Ideal for storing tracings, prints, charts, maps and semi-active reference drawings.
- Three sizes available in 5- and 10-drawer configurations.

Museum Files

- Paint finish formulated to prevent outgassing.
- Enclosed cabinet bottoms prevent entry of dust or mold.

Wood Plan Files

Wood Plan Files combine the natural beauty and finish of wood with the strength and durability of hardwood construction.

- Drawer fronts and case sides are finished in oak.
- Drawer bottoms are hardboard.
- Antique brass drawer pulls.



Vertical Plan Files

The ideal choice for economical, mobile storage of active documents, Vertical Plan Files feature rolling stands with front locking casters.

- Easy-to-use clamps grip sheets securely.
- Clamps and hangers interchangeable with other manufacturers' systems.
- Metal wing knobs and spring-loaded metal mounting clips.
- Perfect for engineering and construction applications.
- Clamps available in 18", 24", 30", 36" or 42" widths.



Mobile B-Size Drawer File

Provides secure, flexible, on-the-go storage for 11" x 17" drawings and artwork.



- Eight drawers with gang lock.
- Actual inside drawer dimensions are 12¾" W x 23½" D x 1¾" H.
- Overall cabinet dimensions are 15¼" W x 27¾" D x 265/8" H.
- Storage for up to 2,500 sheets.
- Four casters; 2 locking.
- Available in Sand Beige, White, Gray and Black.

Roll File Carts

Wire-construction mobile cart includes inserts to accommodate rolled documents of various sizes.



- Available with 36 or 60 openings.
- 2" poly dual-wheel non-scarring casters.
- No tools required for assembly.

Mobile File Cart

Mobile storage for letter size hanging files.



- Heavy-gauge steel construction with 4 non-locking casters.
- Available with or without sliding top and full-extension drawer.
- All units fit under most desks.

Laptop Cart

Lockable mobile carts let you secure and recharge up to 14 laptop computers at the same time.



- Two UL-listed multi-socket power strips in front of unit; cable management holes at bottom of cart.
- Perforated steel doors and back panel for proper ventilation.
- Heavy-duty casters (two locking) for transport.
- Scratch-resistant laminate tops provide a useful work surface.



MAYLINE®

www.mayline.com

CORPORATE LOCATION

MAYLINE
619 N. COMMERCE STREET
PO BOX 728
SHEBOYGAN, WI 53082-0728
CUSTOMER SERVICE 800-822-8037
920-457-7388 (FAX)
customerservice@mayline.com

TO PLACE ORDERS:

MAYLINE
ATTN: ORDER DESK
PO BOX 728
SHEBOYGAN, WI 53082-0728
800-822-8037
920-457-7388 (FAX)
orderdesk@mayline.com

DISTRIBUTION CENTER

ARKANSAS
824 NORTH PALM STREET
NORTH LITTLE ROCK, AR
800-480-3123

SHOWROOM LOCATIONS

ATLANTA
2030 POWERS FERRY RD., SUITE 230
ATLANTA, GA
770-984-9047

BOSTON
850 SUMMER STREET
BOSTON, MA
617-269-7600

CHICAGO
MERCHANDISE MART, SUITE 1147
CHICAGO, IL
847-952-1213

CINCINNATI
2226 GILBERT AVENUE
CINCINNATI, OH
513-221-4800

DALLAS
1109 QUAKER STREET
DALLAS, TX
817-715-2941

DENVER
WELLS FARGO BUILDING
333 S BANNOCK ST, SUITE 310
ENGLEWOOD, CO
720-635-7893

DETROIT
2384 FRANKLIN ROAD
BLOOMFIELD HILLS, MI
248-745-9990

HOUSTON
1213 WEST LOOP NORTH #160
HOUSTON, TX
281-829-1432

LOS ANGELES
12015 MORA DR., UNIT 1
SANTE FE SPRINGS, CA
562-903-7090

NEW JERSEY
HOBOKEN BUSINESS CENTER
50 HARRISON STREET, SUITE 113
HOBOKEN, NJ
212-684-7788

NORTHERN CALIFORNIA
2528 QUME DR., SUITE 6
SAN JOSE, CA
925-786-0178

PORTLAND
5331 SW MACADAM AVE., SUITE 375
PORTLAND, OR
503-222-2364

ST. LOUIS
3204 MORGAN FORD ROAD
ST. LOUIS, MO
314-771-6696

SAN ANTONIO
7340 BLANCO ROAD
SAN ANTONIO, TX
210-744-7428

SEATTLE
829 S. FIDALGO
SEATTLE, WA
206-767-0412

TORONTO
210 PONY DRIVE, UNIT 2
NEWMARKET, ONT
CANADA
905-830-0247

VANCOUVER
110-4611 #6 ROAD
RICHMOND, BC
CANADA
604-272-4401

WASHINGTON D.C.
9000 VIRGINIA MANOR ROAD
SUITE 210
BELTSVILLE, MD 20705
301-408-0600